



COLLEGE
of the DESERT

Annual Security Report 2022



Table of Contents

Table of Contents	3
Palm Desert Campus	5
Indio Campus	6
Palm Springs Campus	7
Mecca Thermal Campus	8
Desert Hot Springs Campus.....	9
KCOD Campus	10
PaCE Westfield Mall Campus.....	11
Letter from the Director of Public Safety	12
Preparation of Disclosure of Crime Statistics	13
Statement Addressing Roles of Public Safety Officers.....	14
Campus Security Authorities (CSA)	14
Reporting of Criminal Offenses.....	15
To Report a Crime	16
“See Something, Say Something”	16
Sexual Assault Policy Statement	17
Sexual Assault Bill of Rights	18
Police Investigation	18
Consent	18
Bystander Intervention	19
Relationship Abuse and Domestic Violence Resources	19
Relationship Abuse	20
Domestic Violence: Call 911	21
Stalking	21
Statement Addressing Sex Offender Registration	22
Timely Warnings	23
Emergency Notifications.....	23

Student Emergency Notifications.....	24
Emergency Notification Systems	25
Emergency Communications.....	26
College of the Desert Fire Safety Policy	27
Who to call in an Emergency	28
Emergency Response and Evacuation Procedures Statement	30
Evacuation Procedures.....	30
Reporting an Emergency	33
Promoting a Safe and Secure Campus Environment.....	34
Drug Free Workplace and Campus.....	36
Student Mental Health Services	37
Student Psychological Services Resources	38
Personal Safety and Crime Prevention	39
Crime Statistics Definitions.....	42
Crime Categories	43
College of the Desert CLERY Act Crime Statistics.....	46
Additional Statistics Required by Education Code 67380.....	53

Palm Desert Campus



Indio Campus



COLLEGE
of the
DESERT

INDIO

40024 OASIS ST, INDIO, CA 92201

DRIVING DIRECTIONS FROM INTERSTATE 10:

TAKE I-10 EAST
EXIT JACKSON STREET (EXIT 143)
TURN RIGHT ONT O REGUA AVENUE
TURN RIGHT ONT O OASIS STREET
INDIO CAMPUS IS ON THE RIGHT



PARKING



BUS STOP



RESTROOMS



ELEVATOR

EMERGENCY EXIT

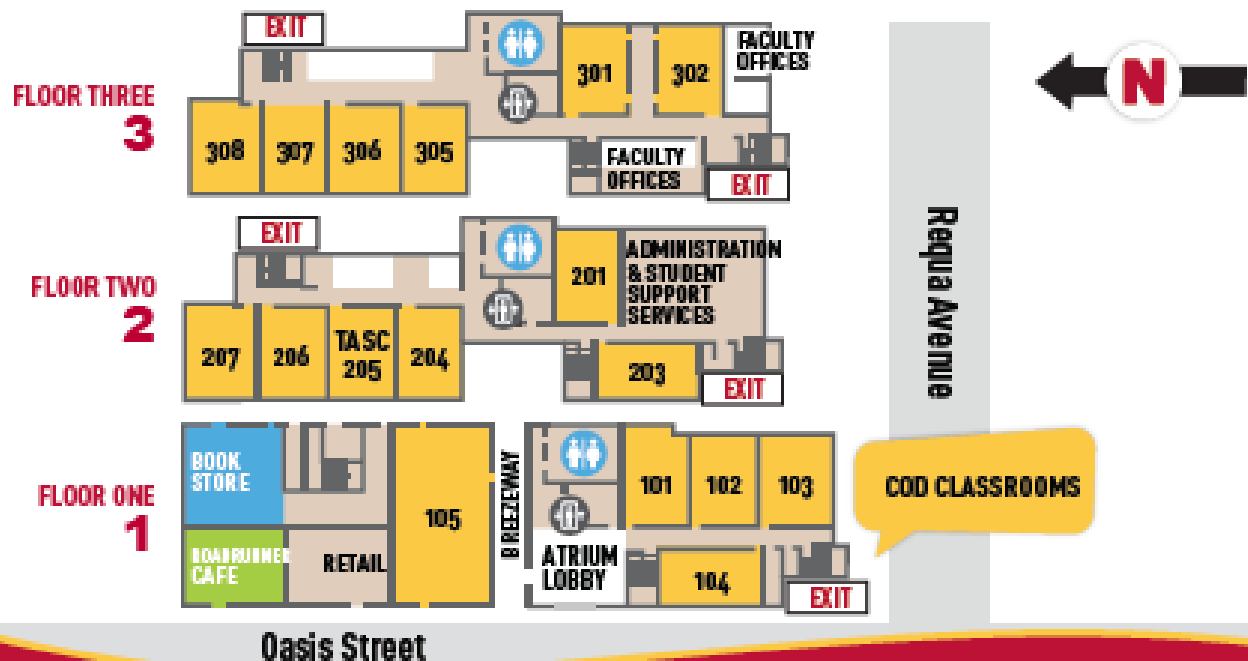
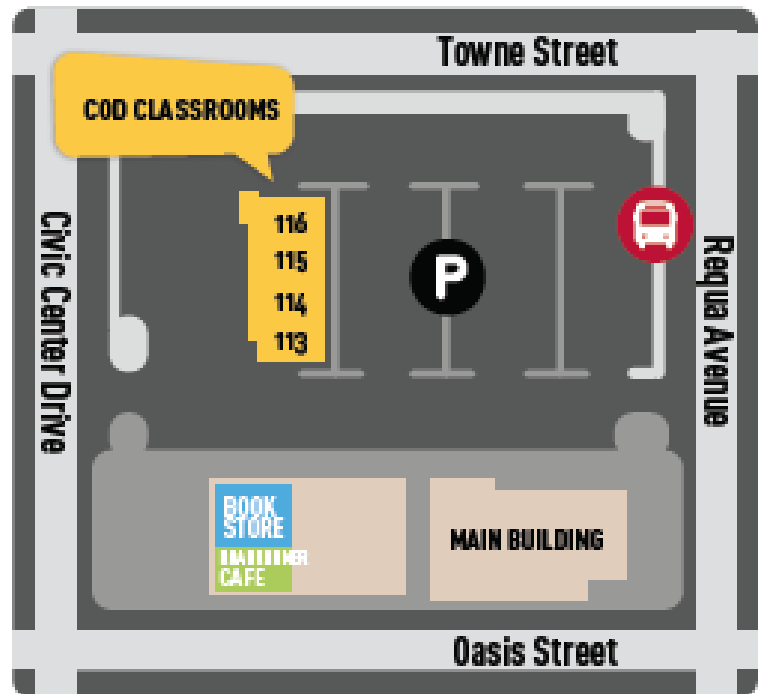

COLLEGEofTHEDESERT.EDU

MAIN NUMBER 760.776.7200
PUBLIC SAFETY 442.666.9439

Palm Springs Campus



COLLEGE
of the
DESERT

TEMPORARY PALM SPRINGS CAMPUS

1510 EAST BARISTO ROAD, PALM SPRINGS, CA 92262

DRIVING DIRECTIONS FROM INTERSTATE 10:

TAKE I-10 TO INDIAN CANYON DRIVE
HEAD SOUTH ON INDIAN CANYON TOWARD PALM SPRINGS
LEFT ON VISTA CHINO
RIGHT ON SUNRISE WAY
RIGHT ON BARISTO
CAMPUS IS ON RIGHT SIDE

TAKE I-10 TO RAMON ROAD
HEAD WEST ON RAMON
RIGHT ON SUNRISE
LEFT ON BARISTO
CAMPUS IS ON RIGHT SIDE

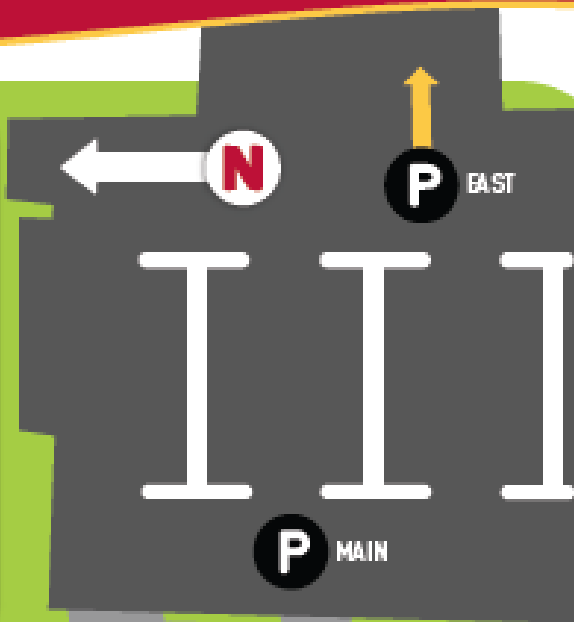

**PUBLIC
SAFETY**



PARKING



RESTROOMS



AED



Hermosa Drive

COLLEGE OF THE DESERT.EDU

MAIN NUMBER
760.674.7800

Mecca Thermal Campus



COLLEGE
of the
DESERT

MECCA/THERMAL

51-120 BUCHANAN STREET, THERMAL, CA 92374

DIRECTIONS FROM PALM DESERT CAMPUS:

TAKE I-10 EAST EXIT 86 EXPRESSWAY SOUTH
(SPLITS TO THE RIGHT)

TAKE A LEFT ON AVENUE 62

TAKE AN IMMEDIATE LEFT ON BUCHANAN ST.

TAKE A RIGHT AT THE FIRST STOP SIGN INTO THE CAMPUS

DIRECTIONS FROM SALTON SEA AREA:

NORTH ON 84 EXPRESSWAY

TAKE A RIGHT ON AVENUE 62

TAKE AN IMMEDIATE LEFT ON BUCHANAN ST.

TAKE A RIGHT AT THE FIRST STOP SIGN INTO THE CAMPUS



PUBLIC SAFETY
760-772-0498



AED



RESTROOMS



PARKING



BUS STOP

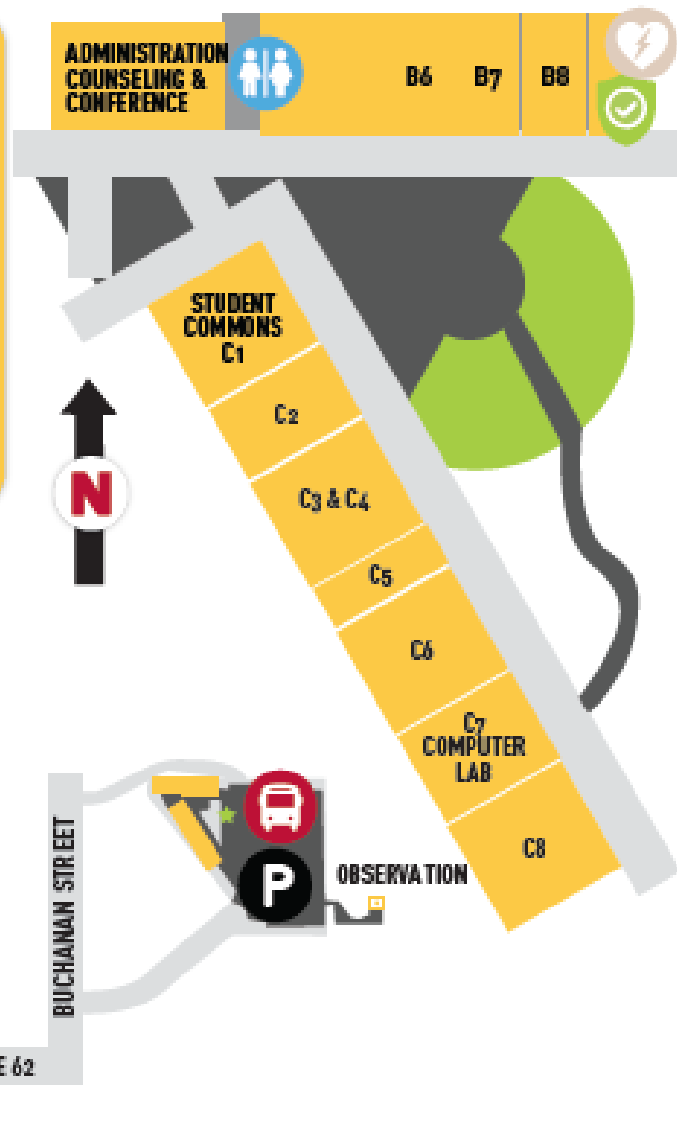

COLLEGE OF THE DESERT.EDU

MAIN NUMBER
760.776.7200

Desert Hot Springs Campus



DESERT HOT SPRINGS

11625 WEST DRIVE, DESERT HOT SPRINGS, CA 92240

Pierson Boulevard

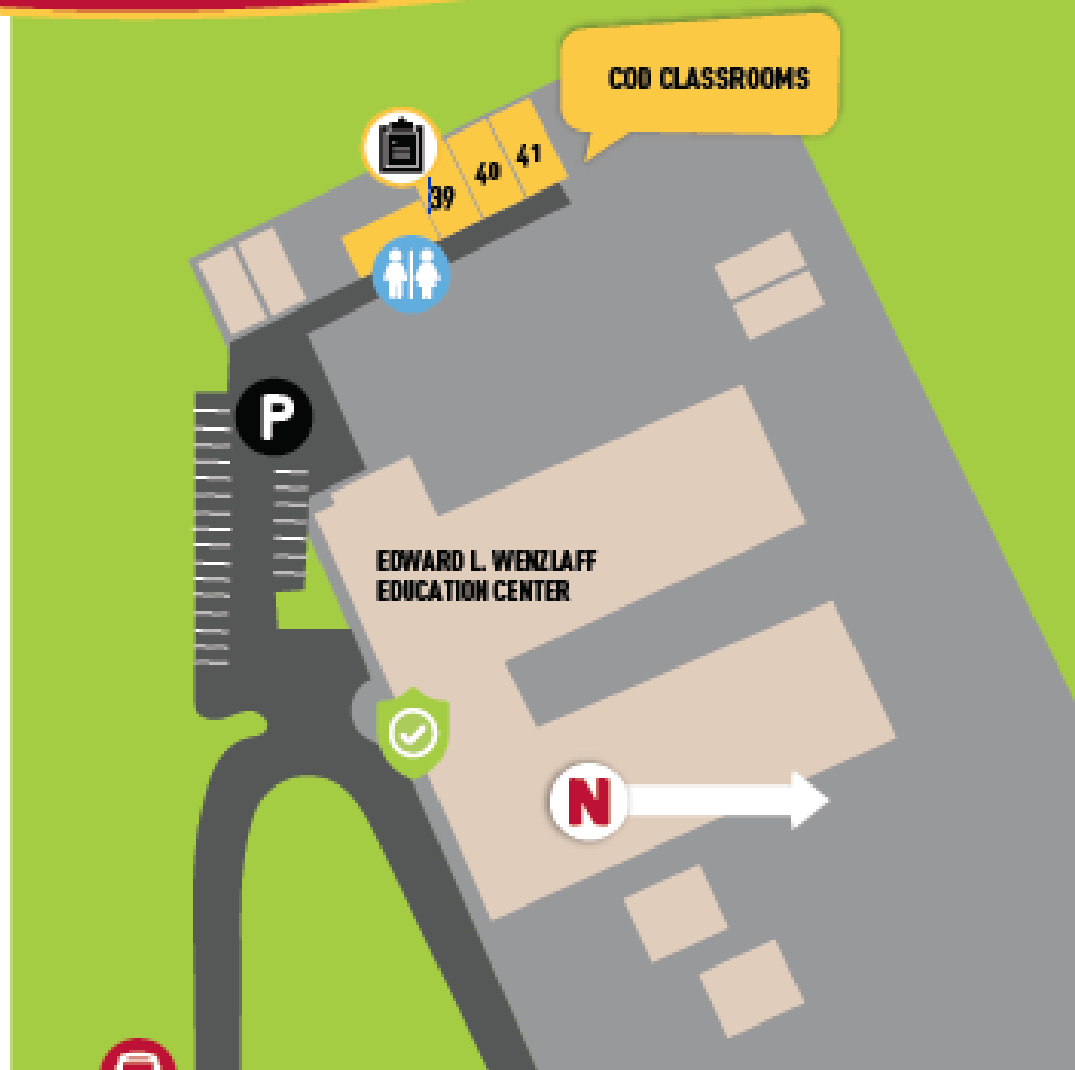

West Drive



PUBLIC SAFETY



RESTROOMS



STUDENT
SERVICES



PARKING



BUS STOP

COLLEGEOTHEDESERT.EDU

KCOD Campus

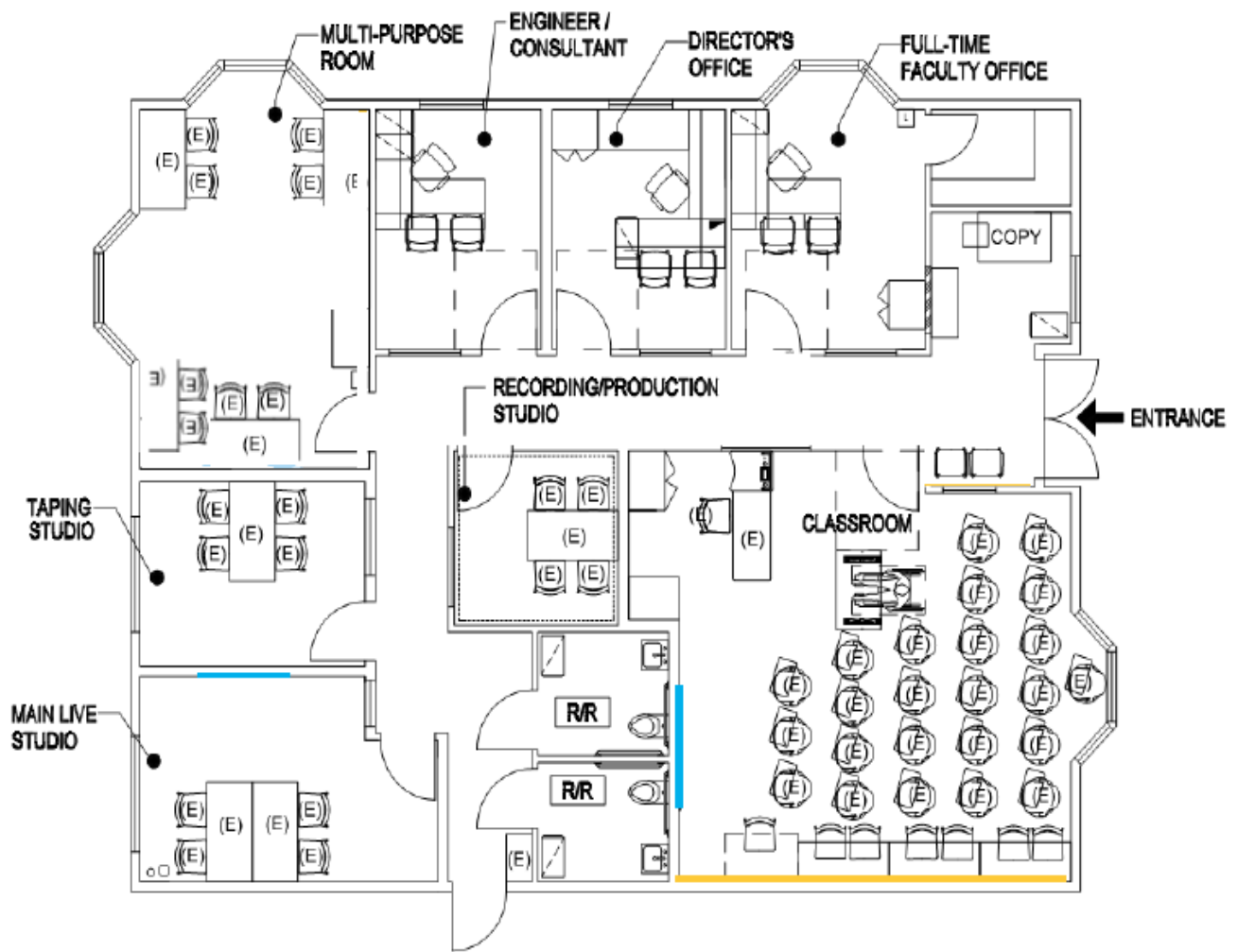

PaCE Westfield Mall Campus

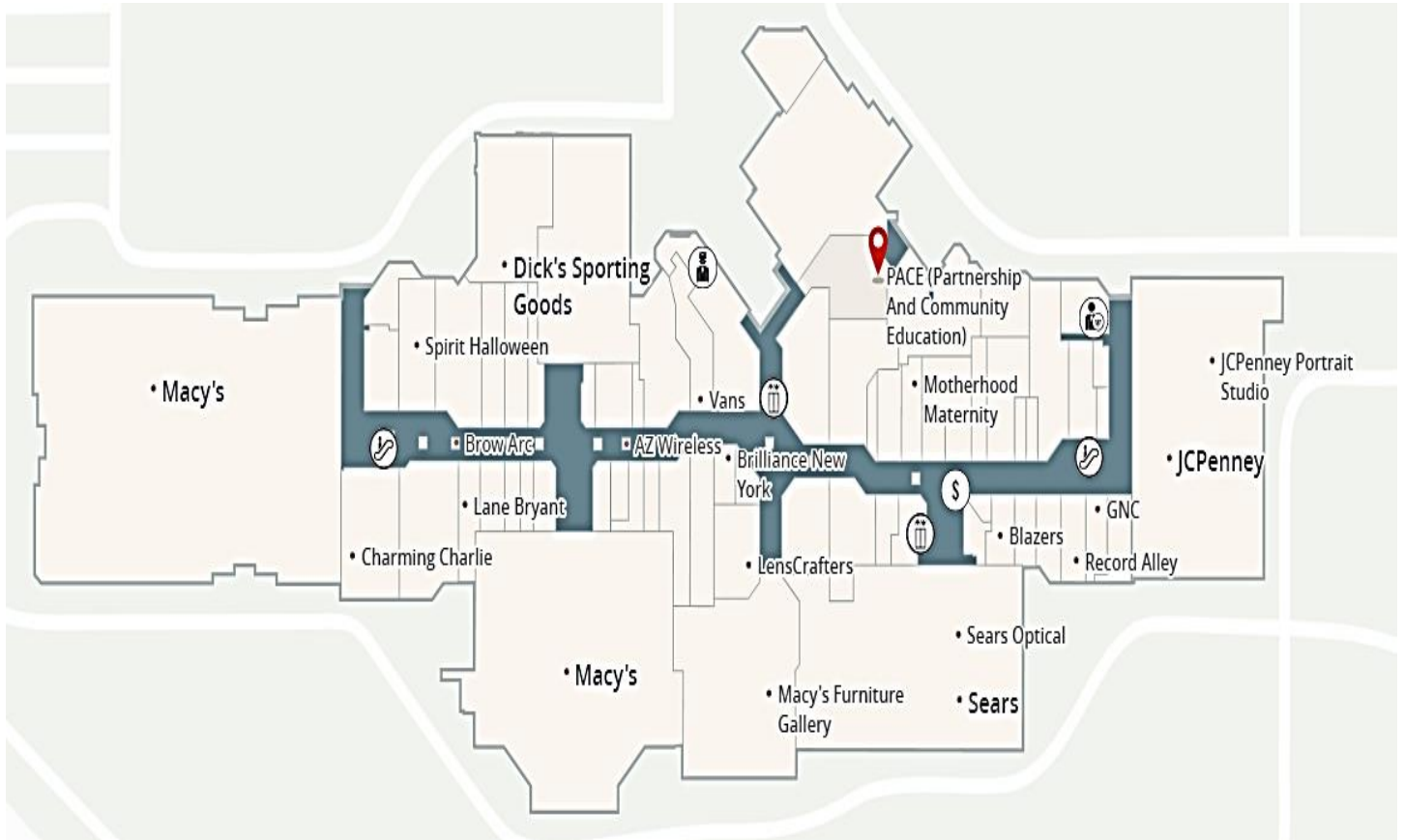



COLLEGE OF THE DESERT

Letter from the Director of Public Safety

Welcome to the Annual Security Report for College of the Desert. This report is prepared pursuant to the Jeanne Clery Disclosure of Campus Security Policy and Campus Crime Statistics Act. The Annual Security Report contains current security and safety-related policy statements, emergency preparedness and evacuation information, crime prevention and sexual assault prevention information, and drug and alcohol prevention programming. This report also includes statistics of reported Clery Act crimes within the District for the three previous years.

The College of the Desert Public Safety Department is committed to the safety and security of every member of our campus community. The continuous low crime rate that we experience in our District is something we have achieved together through sustained and deliberate effort.

As always, we hope the campus community will continue to foster an environment that is conducive to academic growth. The Public Safety Department is committed to that growth as well as your safety and well-being while at College of the Desert. We are dedicated to providing safety and security to all our College of the Desert community and look forward to working with you to make your experience at College of the Desert both positive and rewarding.

Respectfully,



COLLEGE OF THE DESERT
COMMUNITY COLLEGE

Dr. Tim T. Nakamura

Director
Public Safety Department &
Emergency Preparedness

43500 Monterey Avenue
South Annex 16
Palm Desert, CA 92260

760-568-3352 Office
760-636-7975 fax
www.collegeofthedesert.edu

Preparation of Disclosure of Crime Statistics

The College of the Desert (COD) Public Safety Department prepares this report annually to comply with the Jeanne Clery Disclosure of Campus Security Policy and Crime Statistics Act. The full text of this report can be located on our website at: [CLERY Annual Reports](http://www.collegeofthedesert.edu/students/psd/Pages/CLERY.asp) (<http://www.collegeofthedesert.edu/students/psd/Pages/CLERY.asp>). You will also be able to connect to our site via the [College of the Desert homepage](http://www.collegeofthedesert.edu) (www.collegeofthedesert.edu) and put "CLERY" in as a search or by going to College of the Desert Public Safety Department and Emergency Preparedness homepage. This report is prepared in cooperation with, but not limited to, the local law enforcement agencies surrounding the main campus and alternate sites, Campus Safety Authorities, and Campus Public Safety Officers. Data is compiled from the sources and combined to create the crime statistics.

Campus crime, arrest and referral statistics include those reported to the COD Public Safety Department, designated campus officials, and local law enforcement. These statistics may also include crimes that have occurred in private residences or businesses that are near the campus and are not required by law. California law (11160 of the California Penal Code) requires prompt, mandatory reporting to the local law enforcement agency by health care Practitioners when they provide medical services to a person they know or reasonably suspects is suffering from wounds inflicted by a firearm or is a result of assaultive or abusive conduct. The Student Health Center staff inform their clients of the procedures to report crimes to the COD Public Safety Department on a voluntary and/or confidential basis, should they feel it is in the best interest of the client. A procedure is in place to anonymously capture crime statistics disclosed confidentiality during such a session.

Each semester, during the orientation, new students are given information on how to access this report. An email notification is sent to all students and staff. Printed copies of the report may be obtained from the COD Public Safety Department. Copies of the report may also be found online.

Statement Addressing Roles of Public Safety Officers

College of the Desert Public Safety officers have numerous roles on campus. Officers issue parking citations, which are processed from a third-party vendor, Phoenix Information Systems and enforced by the California Department of Motor Vehicles. COD Public Safety Officers do not possess powers of arrest. The role of the COD Public Safety Department is to seek to maintain a safe learning environment. This is accomplished by patrolling and observing campus facilities, parking lots and adjacent areas; protect persons, property; enforce applicable laws, ordinances and serve as a deterrent to undesirable activity.

Multiple local law enforcement agencies have jurisdiction on campuses located within their jurisdiction with a Memorandum of Understanding (MOU). These local law enforcement agencies are Riverside County Sheriff's Department, Indio Police Department, Palm Springs Police Department, Desert Hot Springs Police Department, and Cathedral City Police Department. The Public Safety Department maintains a highly professional working relationship with all of these local law enforcement agencies. All crime victims and witnesses are strongly encouraged to immediately report crime to the COD Public Safety Department or the local law enforcement agency with jurisdiction where the crime occurred. Prompt reporting will assure timely warning notices on campus and timely disclosure of crime statistics.

Campus Security Authorities (CSA)

Campus Security Authority (CSA) Campus Security Authority is a Clery specific term that encompasses four groups of individuals and organizations associated with an institution.

- A campus police department or a campus security department of an institution.
- Any individual or individuals who have responsibility for campus security but who do not constitute a campus police department or a campus security department (e.g., an individual who is responsible for monitoring the entrance into institutional property).

Any individual or organization specified in an institution's statement of campus security policy as an individual or organization to which students and employees should report criminal offenses.

- An official of an institution who has significant responsibility for student and campus activities, including, but not limited to, student housing, student discipline and campus judicial proceedings. An official is defined as any person who has the authority and the duty to take action or respond to particular issues on behalf of the institution. Examples of CSA's, include:

- College Administrative Officers/Assistants

- Title IX

- Student Organization Sponsors

- Deans/Directors

Statistical crime information from COD Public Safety Department, other CSAs, and outside law enforcement agencies such as the Palm Springs Police Department, Desert Hot Springs Police Department, Cathedral City Police Department, Indio Police Department and the Riverside County Sheriff's Department is integrated into a single report, included at the end of this document, on the COD Public Safety Department web page, and provided in a hard copy document upon request. We also submit these statistics to the US Department of Education.

If you are a College of the Desert Campus Security Authority you may file an online report on the College of the Desert website on the public safety department page under CLERY/Annual Security Reports tab

<https://www.collegeofthedesert.edu/students/public-safety/clery.php> and click on [Campus Security Online Reporting Form](#).

Reporting of Criminal Offenses

Faculty, Staff and Students of College of the Desert who are witnesses or victims of a crime should immediately report the crime to the COD Public Safety Department. If you are the victim of a crime and do not want to pursue action within the district's system or the criminal justice system you may still want to consider making a confidential report. With your permission the COD Public Safety Department can file a report on the details of the incident without revealing your identity. The purpose of a confidential report is to comply with your wish to keep the matter confidential, while taking steps to ensure the future safety of yourself and others. With such information, the district can keep an accurate record of the number of incidents involving students, determine where there is a pattern of crime with regard to a particular location, method, or assailant and alert the campus community to potential danger. Reports filed in this manner are reported and disclosed in the annual crime statistics for the institution.

To Report a Crime

Contact the COD Public Safety Department:

Palm Desert Campus
760.341.2111 (24 hours /365 days)

Indio Campus
442.666.9439

Palm Springs Campus
760.777.0498

Desert Hot Springs Campus
760.541.1645*

Mecca Thermal Campus
760.490.8588

KCOD Campus
760.341.2111 (24 hours /365 days)

PaCE Westfield Mall Campus
Security
858.453.0730**

**Westfield Mall Security provides
Security

*Palm Springs Unified provides

"See Something, Say Something"



Sexual Assault Policy Statement

The Desert Community College District, to the fullest extent possible, ensures that students, faculty and staff who are victims of sexual assault committed on or upon the grounds of facilities maintained by the district, shall receive treatment and information to deal with the assault. Sexual assault includes, but is not limited to rape, sodomy, oral copulation, or rape by a foreign object, sexual battery, or threat of sexual assault.

The district recognizes one of the most important ways to assist students, faculty and staff who are victims of sexual assault is to help them regain a sense of control over their lives. The district will make every effort to help the victim aware of the options and alternatives available as well as to aid the victim in making an informed decision as to a course of action.

Applicable state and federal provisions will be applied in maintaining confidentiality in handling of all sexual assault cases. Individual rights to privacy in these matters will dictate District policy, practice and procedure.

During the hours of operation, the Student Health Wellness Center is the referral source for information relating to the rights, options and services available to a sexual assault victim.

After hours, law enforcement personnel, counselors and public safety officers can also assist with this information. If you are a victim of sexual misconduct you may file an online report on the College of the Desert website on the public safety department page under CLERY/Annual Security Reports tab <https://www.collegeofthedesert.edu/students/public-safety/clery.php> and click on [Online Sexual Misconduct Report](#) it will notify the Director of Public Safety and the Title IX coordinator.

Upon request the district will do everything possible to assist the victim with a change in academic schedule.

The National Domestic Violence

HOTLINE

1.800.799.SAFE (7233) • 1.800.787.3224 (TTY)

Sexual Assault Bill of Rights

- Federal law entitles sexual assault victims to certain rights.
- The accuser and the accused have the same opportunity to have
- Others present throughout the disciplinary proceedings.
- Both parties shall be informed of the outcome of any disciplinary proceeding.
- Victims shall be informed of their options to notify law enforcement.
- Victims shall be notified of counseling services available on and off campus.
- Victims shall be notified of options for changing academic and living situations.
- The victim and the accused are entitled to both have someone present during the disciplinary hearing.
- Both parties will be informed of the outcome of any sanctions taken as a result of the disciplinary hearing.
- If found guilty of a sex offense the district maintains the right to expel the accused from any and all campus controlled and owned by the Desert Community College District.

Police Investigation

Reporting a sexual assault to the police may seem intimidating but there is no need to be afraid. Law enforcement officers are trained to handle such situations with sensitivity and compassion. Reporting can help you regain a sense of personal power and control.

Consent

Consent is based on choice. It is informed, freely given, mutually understood, and based on respect and reciprocity. Consent requires an affirmative act or statement by each participant. If coercion, intimidation threats or physical force are used, there is no consent. If a person is mentally or physically incapacitated or impaired so that they cannot understand the fact, nature or extent of the sexual situation, there is no consent. This includes incapacitation due to alcohol/drug consumption or if a person is asleep or unconscious.

Bystander Intervention



Bystanders play a critical role in the prevention of sexual and relationship violence. They are often the largest group of people involved-outnumbering both the perpetrators and the victims. Bystanders can have a range of involvement in assaults. A person or persons may be aware that a specific assault is happening or will happen, they may see an assault or potential assault in progress, or they may have knowledge that an assault has already occurred. Regardless of how close to the incident they are, bystanders have the power to stop assaults and to get help for people who have been victimized.

The Bystander Intervention Model

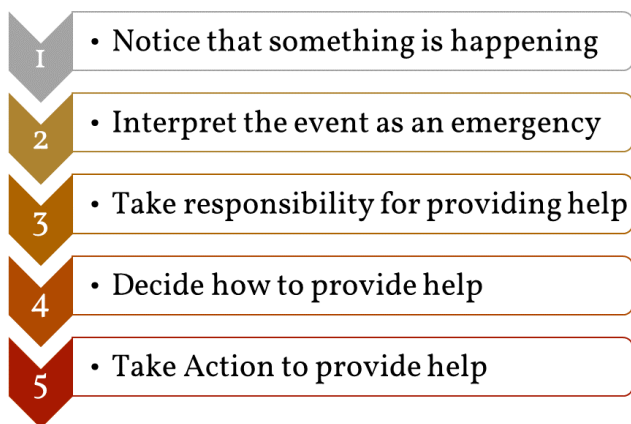

Relationship Abuse and Domestic Violence Resources

There are many resources for victims who are unsure what to do when dealing with domestic violence. One option is the criminal justice system. Do not be afraid to call the police if you have been abused. The goal of the police and legal system is to provide some measure of safety for victims of violence and to provide information about additional resources, such as temporary living accommodations if necessary. One immediate alternative is to obtain a Temporary Restraining Order. If you have been recently threatened, hurt or abused, or are being stalked by your current or former intimate partner call 9-1-1. Tell the dispatcher that you are in danger and that you need help immediately. The police are required to write an incident report for all domestic calls, even if the batterer has already left the scene. Although it is best to make the report as soon as possible, you may call the police anytime, even days or months after you have been abused.

Relationship Abuse

Relationship abuse is a pattern of abusive or coercive behaviors used to maintain power and control over a former or current intimate partner. Abuse can be emotional, psychological, financial, sexual or physical and can include threats, isolation and intimidation.

Could you be in an abusive relationship?

- Are you afraid of your partner?
- Do you avoid certain topics of conversation out of fear it will anger your partner?
- Does your partner humiliate or belittle you?
- Does your partner have a bad or unpredictable manner?
- Does your partner destroy your belongings?
- Does your partner seem unusually possessive or jealous?
 - Does your partner force you to have sex?
 - Does your partner keep you from seeing friends or family?

If you answered yes to any of these questions – understand that you are not at fault! You deserve to be treated with dignity and respect – especially by your romantic partner. Emotional abuse is often a precursor to physical violence.



Visit Verbal Abuse Journals for a comprehensive safety plan.

Domestic Violence: Call 911



Call 911 if you have recently been threatened, hurt, abused or are being stalked by your current or former intimate partner.

Domestic violence is broadly defined as physical or sexual assault and/or other threatening and abusive behavior including stalking, harassing or destroying personal property perpetrated against a former or current intimate partner, relative or person living in the same household.

Stalking

Stalking as defined below, is a violation of District policy and a reportable offense under the Jeanne Clery Disclosure of Campus Security Policy and Crime Statistics Act.

Stalking means engaging in a course of conduct directed at a specific person that would cause a reasonable person to:

- fear for their safety or the safety of others; or
- suffer substantial emotional distress.

Stalking behaviors may include:

- Following or “Cyberstalking” using GPS, Keystroke Capture devices, etc.
- Unwanted communication
- Unwanted or threatening gifts
- Obsessive behavior
- Appearing at a place of residence, school or work
- Inappropriate approaches, confrontations or threats

If you believe you are being stalked:

- Report to a public safety officer as soon as possible
- Be clear and assertive in demanding to be left alone
- Document each incident. Include dates, times, locations and a detailed description of what happened. Keep letters, notes and gifts or other objects sent to you. It may be important evidence.

Statement Addressing Sex Offender Registration

In accordance to the "Campus Sex Crimes Prevention Act" of 2000, which amends the Jacob Wetterling Crimes Against Children and Sexually Violent Offender Registration Act, Jeanne Clery Disclosure of Campus Security Policy and Crime Statistics Act and the Family Education Rights and Privacy Act of 1974, the COD Public Safety Department has provided a link to [Megan's Law](https://www.meganslaw.ca.gov/) (<https://www.meganslaw.ca.gov/>), the national registered sex offenders data base.



Effective September 24, 2004, Penal Code section 290.46 required the Department of Justice to create a website on or before July 1, 2005. There are four categories of registered sex offenders for purposes of disclosure on the Megan's Law internet website.

Home Address Category

The conviction of certain sex offenses requires that the home address of the offender be posted along with other information about the registrant. 290.46, sub. (b).

Conditional Home Address Category

The conviction of other designated sex offenses, along with the conviction of any other registrable sex offense, requires that the homes address be posted, along with other information about the registrant. 290.46, sub. (c).

Zip Code Category

Commission of certain other sex offenses requires that information about the offender, including their zip code and other information, but not including the home address, be posted on the web site. 290.46, subd. (d).

Undisclosed Category

Finally, there is a category of registered sex offenders that may not be displayed on the internet website. These are registrants who have been convicted of sex offenses not listed in the above three categories. Offenders in the undisclosed category must still register as sex offenders with local law enforcement agencies and are known to law enforcement.

Timely Warnings

In the event of an emergency, the Director of Public Safety and emergency Preparedness Department (or designee), is to be notified and will determine if an emergency notification is to be sent out. In the event of his absence, the COD President, or Vice President of Administrative Services will determine if a warning will be issued. Considering the safety of the community, the content of the notification and determine how the notification will be issued, unless notification in their professional judgement will compromise efforts to assist a victim or to contain, respond to, or otherwise mitigate the emergency.

In the event an emergency, and notification is necessary, COD can post information on its website, social media accounts, email and text students, staff and faculty, transmit information on KCOD, loudspeakers or telephones speakers. After it is determined the threat is over, COD will provide follow up information in the same manner it was issued.

Anyone with information warranting a timely warning should report the circumstances immediately to the Public Safety Department Officers at any Public Safety Department office on their campus. If not in person, then over the telephone at the main number 760-341-2111.

Emergency Notifications

The Director of the COD Public Safety Department (or designee) or other senior COD officials will, without delay, utilize the emergency notification system to issue an immediate notification to the campus community upon first responder confirmation of any emergency or dangerous situation that poses an ongoing or continuing threat to the health or safety of the campus community. The nature of the incident will determine which of the following methods will be employed:

The notification will be sent to all students, faculty and staff in the COD community (or an appropriate segment of the community if the event is limited to a defined area of the campus) using Emergency Notification System unless issuance of the notification will, in the professional opinion of responsible authorities, compromise efforts to assist a victim or contain, respond to, or otherwise mitigate the emergency. The content of the message will vary dependent on the situation, but will typically include the incident time, location, type and recommended actions for safety.

Individuals Authorized to Initiate an Emergency Notification

These include the Director of the COD Public Safety Department (on-scene Incident Commander or designee), or other senior COD official.



Student Emergency Notifications

In the event of an actual emergency the campus community will be notified via notification on the portal, notification on the COD webpage, Campus telephone speakers, broadcast exterior/outdoor speakers to outside open areas, campus email, and or student email, KCOD broadcast, phone calls, and text messages as well as COD social media accounts. In order to receive campus-wide email announcements, students must have a college email account. Students can obtain an email account by signing up on the college [Emergency Notifications](https://www.collegeofthedesert.edu/emergency.php) website (<https://www.collegeofthedesert.edu/emergency.php>). Help is available by contacting the Counseling Center: 760-346-8041 ext. 2521 or Student Life: 760-346-8041 ext. 1311.

Additionally, our mass notification system includes RAVE. This system sends alerts via text. All student phone numbers that are used during registration will be uploaded into the system for a mass notification text messaging. Should a student no longer want to receive a text, a student must "opt out".



Emergency Notification Systems

Depending on the type of emergency, you will be notified in one of the following ways:



E-mails will be sent to your registered email on file with the college which should be <Your Login>@mycod.us. Please ensure that you check this email regularly as non-emergency notifications are also sent here that contain important information from not only the college, but also your instructors during the semester.



The website (collegeofthedesert.edu) is routinely updated with important information and should also be checked on a regular basis. As a full-time or part-time student perhaps consider making it your homepage on your laptop, tablet, home computer or smart phone browser.

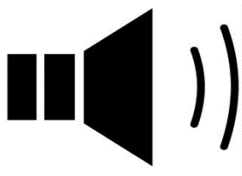

The college has installed powerful speakers that will broadcast information of a critical nature both in the interior and exterior of the campuses. Additionally, most buildings have wall or roof mounted speakers in common areas and in classrooms.



All classroom and office phones can be used to send out information similar to the high-powered speakers. This includes phones at satellite campuses such as Indio, Palm Springs, Mecca/Thermal or Desert Hot Springs. During an emergency the college will use any and all avenues available to distribute critical information.



College of the Desert utilizes a variety of emergency notification systems to communicate official information during an emergency or crisis situation that disrupts normal campus operations or threatens the health or safety of members of the campus community. Our mass notification system sends alerts in all communication modes through alerts via text, email and voice.



KCOD (1450 AM) is a radio station owned by College of the Desert. It serves the Coachella Valley area. Programming is also simulcast on translator station K260DE (99.9 FM) in Palm Desert. In an emergency, notifications would be broadcast on this station for staff and students.

Any questions you may have regarding emergency notifications can be directed to College of the Desert Public Safety Department:

Palm Desert Campus	760.341.2111 (24 hours /365 days)
Indio Campus	442.666.9439
Palm Springs Campus	760.777.0498
Mecca Thermal Campus	760.490.8588
Desert Hot Springs Campus	760.351-6834*
KCOD Campus	760.341.2111 (24 hours /365 days)
PaCE Westfield Mall Campus	760.568.2364**

*Palm Springs Unified provides Security

**Westfield Mall Security provides Security

Emergency Communications

The community is encouraged to report crimes, fires, suspicious activity, requests for medical assistance, and other public safety related incidents immediately.



Call 9-1-1 when you experience or observe:

- A whistle, scream or call for Help
- Any crime in progress or that has occurred
- Suspicious behavior or activity including:
 - A car suspiciously driving up and down the street repeatedly
 - Someone entering a room, office or lab without permission
 - Someone lurking around a parking lot, bike racks or a building

For immediate police, fire or medical response:

- **Dial 9-1-1** from any phone or cell phone.
 - Calling 9-1-1 from a pay phone is free.
- Provide the dispatcher with a description of the incident type, location, time of occurrence, any injuries, weapons involved, the suspect (e.g., gender, height, complexion, attire) and associated vehicles (e.g., license plate, make, model color and direction of travel).

For a non-emergency response on any COD Campus dial:

Palm Desert Campus	760.341.2111
Indio Campus	442.666.9439
Palm Springs Campus	760.777.0498
Mecca Thermal Campus	760.490.8588



College of the Desert Fire Safety Policy

It is the Desert Community College District's policy that any fire that is a result of negligence or purposely set required the local fire department as well as the Public Safety Department to be contacted. The COD Public Safety Department will be responsible for follow up with the local police department to file a report.

The cause of the fire will be determined by the appropriate fire department personnel. The report will include the cause of the fire as well as the estimated value of property damage. The property damage will include the value of the loss of structure and contents, in terms of the cost of replacement. It is COD Public Safety Department's responsibility to request a copy of the report 10 days after the incident and maintain a copy for their file as well as provide a copy to the appropriate College personnel.

Responsibility of Supervisors, Managers and Faculty

The supervisor, manager and instructor are to supervise the clearing of their area during an emergency evacuation, in an orderly manner using the designated evacuation paths to the designated safety areas. Attendance will be taken from each area evacuated with a class roster. The Dean of each department will be responsible to ensure that all instructors have a copy of their class roster.

Fire Drills

Fire drills are important because they prepare you for what you should do in a real emergency. When you hear an alarm go off, you may not know for sure whether it is a drill or an emergency so treat every drill like it is the real thing.

Fire Safety System

College of the Desert uses Simplex/JCI- Johnson Controls as its fire system. The Simplex 4100 fire system has 4 general functions:

- It monitors for alarm initiating points (smoke detectors, heat detectors and pull stations)
- It activates fire alarm notification appliances (horns, strobes, audio evacuation messages) when an initiating point activates.
- It monitors and controls auxiliary building equipment (fan dampers, relays, security devices).
- It contacts appropriate departments and outside public safety agencies.



Who to call in an Emergency?

9-1-1	Emergencies
2-1-1-1	Public Safety Department monitored 24/7 365 days a year (campus desk extension)
760-341-2111	Public Safety Department Palm Desert
442-666-9439	Public Safety Department East Valley Indio
760-777-0498	Public Safety Department West Valley Palm Springs
760-490-8588	Public Safety Department Mecca Thermal

Security provided by other than COD Public Safety Department:

760-351-6834	Security at DHS/Wenzlaff
760-568-2364	Security at PaCE Westfield Mall

It is recommended that you place COD Public Safety Department's phone number into your cell phone as a speed dial number- then all you have to do is push one button in case of an emergency. *Remember 760-341-2111 is monitored 24/7, 365 days a year.

Note: You may dial 9-1-1 from any campus phone and it will alert Public Safety automatically. You can dial 8-9-1-1 or 9-1-1, either will dial the emergency services. If you dial from a cellular telephone, it will not automatically alert Public Safety but will go directly to a 911 dispatch center.

Reporting Facilities Use Issues

To report other problems with campus facilities, call the Maintenance and Operations department at extension 2551 or at 760-776-2551 in case of:

- Electrical Outages
- Gas Leaks
- Water Problems
- Air Conditioning



Emergency Response and Evacuation Procedures Statement

COD conducts emergency response trainings every year which can include table top exercises, tests of the emergency notification system, field exercises involving the local fire department personal and local law enforcement. These tests are done to assess and evaluate the emergency plans and capabilities of the college.



Evacuation Procedures

Remain calm and determine the nature and location of the disaster.

Emergency Assembly Areas at each District Campus

Palm Desert

There are two areas to assemble to in the event it is safe to do so:

- West side assembly area for those on the west side of campus would be the Amphitheater between the Communications Building and the Cravens Student Center if safe to do so. It will also serve as the emergency first aid station. In the event this site is not useable, utilize the east side assembly area.
- East side assembly area for those on the east side of campus would be the football field if safe to do so. It will also serve as the emergency first aid station. In the event this site is not useable, utilize the west side assembly area.

Palm Desert Procedures for Instructional/Office Staff on Attendance Tracking

The primary causes for evacuation will most likely be fire or earthquake. COD faculty/staff be prepared to react quickly and properly. Faculty should use their class roster to ensure accurate accounting of attendance.

East Valley Indio Campus

East side of the parking lot near Towne Street is the assembly area for the Indio campus if safe to do so. This will serve as the emergency first aid station. In the event that this area is not useable, utilize the parking lot across to either the south or west of the building.

Indio Procedures for Instructional/Office Staff on Attendance Tracking

The primary causes for evacuation will most likely be fire or earthquake. COD faculty/staff be prepared to react quickly and properly. Faculty should use their class roster to ensure accurate accounting of attendance.

West Valley Palm Springs Campus

Main Parking Lot east of the buildings is the assembly area for the Palm Springs campus if safe to do so. It will also serve as the emergency first aid station. In the event this area is not useable, utilize the sidewalk across the street to the north of the buildings.

Palm Springs Procedures for Instructional/Office Staff on Attendance Tracking

The primary causes for evacuation will most likely be fire or earthquake. COD faculty/staff be prepared to react quickly and properly. Faculty should use their class roster to ensure accurate accounting of attendance.

Mecca Thermal Campus

The east area of the main parking lot is the assembly area for the Mecca Thermal campus if safe to do so. It will serve as the emergency first aid station. In the event the area is unusable, utilize the area across the road to the west.

Mecca Thermal Procedures for Instructional/Office Staff on Attendance Tracking

The primary causes for evacuation will most likely be fire or earthquake. COD faculty/staff be prepared to react quickly and properly. Faculty should use their class roster to ensure accurate accounting of attendance.

Desert Hot Springs Wenzlaff Campus

The assembly area is the parking lot near the Security office if safe to do so. This area will also serve as the emergency first aid station. If this area is unusable, then utilize the parking lot to the east of the buildings.

Desert Hot Springs Procedures for Instructional/Office Staff on Attendance Tracking

The primary causes for evacuation will most likely be fire or earthquake. COD faculty/staff be prepared to react quickly and properly. Faculty should use their class roster to ensure accurate accounting of attendance.

KCOD Campus

The assembly area for KCOD, if it is safe to do so, would be the parking lot to the east side of the buildings. This area will serve as the emergency first aid station. If that area is unusable, then utilize the Church parking lot across the street to the North.

KCOD Procedures for Instructional/Office Staff on Attendance Tracking

The primary causes for evacuation will most likely be fire or earthquake. COD faculty/staff be prepared to react quickly and properly. Faculty should use their class roster to ensure accurate accounting of attendance.

PaCE Westfield Mall Campus

The assembly area would be the parking lot to the north or south of the mall if safe to do so. These areas will serve as the emergency first aid station. In the event that either area is unusable, then utilize the opposite parking lot.

PaCE Procedures for Instructional/Office Staff on Attendance Tracking

The primary causes for evacuation will most likely be fire or earthquake. COD faculty/staff be prepared to react quickly and properly. Faculty should use their class roster to ensure accurate accounting of attendance.

Faculty

Depending on the event that caused the emergency, stay in the assembly area, again if safe to do so. Directions will be given out when available or as needed through the mass communication methods.

Office Areas

Depending on the event that caused the emergency, stay in the assembly area, again if safe to do so. Try to take attendance and await further direction. In all cases, be certain that injured or disabled are evacuated and cared for; all students and staff are accounted for if possible; and the alarm has been sounded (or reported to Public Safety or 9-1-1 if applicable) if you or someone in your class was the first to discover the potential disaster.



Reporting an Emergency

In an emergency call 911 or the COD Public Safety Department on a campus telephone at extension 2111 or dial on a cell phone (760)341-2111.

An emergency is any situation that requires immediate police, fire or medical response to preserve life or property. The COD Public Safety Department at 2111 can be called from every phone on campus. If 9-1-1 is called from a campus phone, Public Safety Officers are alerted immediately as well as the local police, fire and/or ambulance responders. To report a campus emergency on a cell phone call (760)341-2111. This number is monitored 24/7, 365 days a year. To dial 9-1-1 from a desk extension just dial 9-1-1.

Call COD Public Safety Department to report problems such as:

- Assault or immediate danger of assault
- Chemical Spills
- Crimes in Progress
- Explosives
- Fires
- Severe Injuries or illnesses
- Medical Emergencies
- Unusual Odors
- Person out of control or acting erratically



If you are calling on a campus phone, COD Public Safety officers will respond directly to your call and route it to the appropriate emergency responders. COD Public Safety Officers will meet the first responders and direct them to the proper location. You can also use any phone to report a campus emergency.

When reporting an emergency, be prepared to give the following information:

- Location of the emergency – directions, street address, building and room
- Type and severity of the emergency, i.e.
- Fire and type and size of fire
- Medical type of illness or injury, cause, number of victims
- Police/crime – type of crime, description of suspects and their direction of travel
- Chemical hazardous materials – quantity and type of substances involved, hazards and injuries
- When the incident occurred
- Your name, phone number and location

Call from a safe location, if possible. Remain Calm. Speak slowly and clearly, do not hang up the phone until the dispatcher tells you to.



Promoting a Safe and Secure Campus Environment

Violence in the Workplace/Campus

College of the Desert will not tolerate violence or threats of violence on campus or in connection with District events. All weapons, as defined by California Penal Code, are banned from College premises unless written permission is given by the COD Public Safety Department.

Employees who violate this policy (or bring false charges) will be subject to corrective action, including termination.

Students who violate this policy could be in violation of the Student Code of Conduct and subject to disciplinary action ranging from a formal warning to expulsion.





Weapons on Campus

All weapons are prohibited on the College of the Desert Campus. Except for sworn law enforcement officials, it is a felony to bring or possess any firearm on any California school campus (§626.9 PC). It is also a felony to possess any air gun – including a pellet, and BB guns that utilize air, CO2 or spring pressure to propel a metallic projectile (§626.10 PC). Knives with a blade length over 2.5 inches, dirks, daggers and ice picks are also illegal. Individuals with Carry Concealed (CCW) permits may not carry a weapon on campus without written permission from the Director of the COD Public Safety Department.



Violence Prevention

Education, communication, collaboration, resource coordination and early intervention are the cornerstones of College of the Desert's violence prevention efforts. The single most important component of violence prevention is the timely communication of concerning behavior to the appropriate resources.

COD Assessment and Care Team is available to report incidents of concern. These reports are made online using the [ACT Incident Report](https://collegeofthedesert-advocate.symplicity.com/care_report/) (https://collegeofthedesert-advocate.symplicity.com/care_report/). This team meets to address issues and incidents of concern.

Drug Free Workplace and Campus

The district intends to maintain a safe, healthy and productive work and learning environment for all employees and students. To accomplish this, the district will act to eliminate any drug abuse, which increases the potential for accidents, absenteeism, low academic and work performance, poor employee and student morale and damage to the district's reputation. The unlawful manufacture, distribution, dispensation, possession of alcohol is prohibited in all buildings, property, facilities, and service areas, off campus sites of the district or in any location where any District activity is occurring.

The district shall discipline a student, up to and including expulsion, for the unlawful manufacture, distribution, dispensation, and possession of a controlled substances (as defined by Federal and State laws) on the district's property or as a part of any of its activities. Though marijuana has been legalized in the state of California, it is prohibited on all District property. The district shall discipline a student, up to and including expulsion, for the use, manufacture, distribution, dispensation or possession of marijuana on the district's property or as part of any of its activities.

Students who think they may have an alcohol or drug usage problem are urged to voluntarily seek confidential assistance from the Student Health Center. While the District will be supportive of those who seek help voluntarily, the district will be equally firm in identifying and disciplining those students who continue to abuse drugs or alcohol after treatment or counseling.

Materials and information on counseling, treatment and rehabilitation resources, health risks and uses and effects of controlled substances are available at the Student Health Center located in the Craven's Student Services Center.



FreeSignPrinter.com

Student Mental Health Services

Mission Statement

The mission of the Student Mental Health Services is to promote student development and retention by addressing personal coping skills and everyday mental health needs of students. This is accomplished by providing short term personal counseling, responding to emotional crises, building awareness of mental health issues within the college community, and by collaborating as much as possible with local community resources.

As students meet their personal challenges and develop a sense of competency and self-responsibility, their chances of academic success are increased.

- Location: Craven's Student Services Center, 1st Floor
- Hours: Monday-Thursday 9:00 am – 4:00 pm and every Other Friday
- Contact: 760-776-7211

Please check the College of the Desert website: [Student Health & Wellness](#)



Why would I need Student Mental Health Services?

Life for college students can be stressful at times. Many people experience times in their lives when some type of outside assistance would be helpful in order to look at a situation more objectively, explore options and identify new solutions or strategies. This help can come from various sources. Students at College of the Desert are eligible to receive psychological counseling from a trained professional.

Is there a fee?

Student Mental Health Services is a free service for students. These services and a variety of other student health services are funded by your student health fees paid at the beginning of each semester.

What services are provided?

- ✓ Confidential Psychological Counseling (for personal problems or questions)
- ✓ Brief Preventive Intervention (prompt assistance for urgent matters, such as a significant personal or mental health emergency)
- ✓ Evaluation/Screening (short tests to screen for depression, anxiety or other psychological symptoms or disorders)
- ✓ Referrals (to on-campus departments or to off-campus resources for more specialized services)
- ✓ Information (print information and education presentations related to mental health and wellness)

How do I schedule an appointment?

Call 760-776-7211 or come in to the Craven's Student Services Center on the first floor.

Student Psychological Services Resources

Riverside County Department of Mental Health

RCMH provides treatment for severe psychiatric disorders interfering with basic daily functioning or involving suicidal thoughts or intent. **Patients must have Medi-Cal or other health insurance to receive services, unless it is a psychiatric emergency.

- Looking for services call: 1-800-706-7500
- or on the web: <https://www.rcdmh.org>

Indio Mental Health Clinic

Outpatient clinic providing services for children, adolescents, adults and older adults including crisis intervention, assessment, medication services, case management and dual-diagnosis services. Peer to peer recovery services is provided through the clinic and through the contracted Peer Support and Resource Center. Outreach to homeless mentally ill individuals, housing assistance and 24 hour a day, seven days a week intensive case management is available through the Desert's Full-Service Partnership (FSPs) Programs. Parent Partners provide support to parents of children.

- Address: 47-825 Oasis Street, Indio, CA 2201
- Phone: 760-863-8455
- Fax: 760-863-8587
- 24/7 Crisis Line: 951-686-4357

Crisis Services: Oasis Crisis Service (OCS) Oasis Rehabilitation Center

Provides psychiatric emergency assessment and crisis stabilization for up to 24 hours for all ages. Services include evaluations, crisis intervention and referral for psychiatric hospitalization. This facility is a 5150 designated provider, which operates 24 hours a day 7 days a week.

- Address: 47-915 Oasis Street, Indio, CA 92201
- Phone: 760-863-8600
- Fax: 760-863-8603

Psychiatric Healthy Facility (PHF) Oasis Rehabilitation Center

Low-cost County Mental Health satellite clinics which provide outpatient evaluations; clinics are located in Mecca, Thermal, Palm Springs and Bermuda Dunes. Costs for services varies and there is a sliding fee scale for uninsured.

- Address: 47-915 Oasis Street, Indio, CA 92201
- Phone: 760-863-8632
- Fax: 760-863-8631



Riverside County Dept. of Mental Health, Substance Abuse Program

Outpatient drug and alcohol counseling for adults, adolescents and new mothers; the program takes Medi-Cal on sliding fee scale based on income.

- Address: 83-912 Avenue 45, Suite 9, Indio, CA 92201
- Phone: 760-347-0754



Personal Safety and Crime Prevention

College of the Desert participates in the See Something Say Something campaign to keep our campuses safe. Report any suspicious activity or behavior to the Public Safety Department or local law enforcement immediately, including:

- Solicitors
- Peeping or Prowling
- Any activity or behavior that is threatening persons or property



"See Something, Say Something"



Lock it or Lose it

- Lock your doors anytime you leave your office or residence
- Never prop open a locked door
- Don't allow "piggybacking" (when someone unknown to you tries to enter a locked building behind you)
- Report broken or malfunctioning locks to the Maintenance and Operations Department
- Lock your vehicle and do not leave valuables exposed
- Avoid becoming a target of thieves by securing "hot" items:
 - Secure laptops in a closet or drawer or secure to a fixed object with a cable lock
 - Secure bicycles to a bicycle rack with a U-lock, register your bicycle with the Public Safety Department and local law enforcement

Prevent Identity Theft

- Protect your Social Security number and card
- Shred paperwork with your personal information
- Never click on links in unsolicited emails
- Inspect your credit report and financial statements regularly
- Take advantage of the [Federal Trade Commission's Identity Theft resources](http://www.ftc.gov/bcp/edu/microsites/idtheft) (<http://www.ftc.gov/bcp/edu/microsites/idtheft>)
- If you are a victim of Identity Theft, seek [victim assistance](http://www.identitytheftcouncil.org) (<http://www.identitytheftcouncil.org>)

Online Security

- Take advantage of the [Federal Trade Commission's Online Security resources](https://www.consumer.ftc.gov/topics/online-security) (<https://www.consumer.ftc.gov/topics/online-security>)
- Notify the police in your local area immediately if a computer containing any sensitive or confidential information has been stolen.

Crime Statistics Definitions

Geographical Locations

- **Campus:** Any building or property owned or controlled by an institution within the same reasonably contiguous geographic area and used by the institution in direct support of, or in a manner related to, the institution's educational purposes, including residence halls; and any building or property that is within or reasonably contiguous to the area identified above, that is owned by the institution but controlled by another person, is frequently used by students, and supports institutional purposes (such as a food or other retail vendor).
- **Non-Campus:** Non-campus Building or Property—Any building or property owned or controlled by a student organization that is officially recognized by the institution; or any building or property owned or controlled by an institution that is used in direct support of, or in relation to, the institution's educational purposes, is frequently used by students, and is not within the same reasonably contiguous geographic area of the institution. Crime statistics from Clery geographic locations defined as "non-campus buildings and property" (known as "non-campus" locations) encompass two distinct types of geography associated with COD: (1) buildings and property owned or controlled by officially recognized student organizations; and (2) buildings and property located off campus but owned or controlled by COD. Non-campus buildings and property are located at numerous locations throughout Riverside County, and other various geographic locations away from COD. Non-campus locations are neither contiguous to nor located within a reasonable geographic area surrounding COD property and these locations fall within the jurisdiction, protection, and reporting responsibility of different law enforcement agencies depending upon where the buildings and property may be located. The COD Public Safety Department requests Clery crime statistics from all local law enforcement agencies that have jurisdiction where COD owns or controls buildings or property within their jurisdiction. Additionally, non-campus buildings and property may also include locations such as hotels, resorts/conference centers, temporary classrooms, etc. where officials on behalf of COD may own or control such space by virtue of an agreement and where the location is used for educational purposes, students go to the location, and it is not contiguous to the COD campus. Any type of agreement (e.g., a contract, reservation, invoice, receipt, etc.) may be used to establish an "agreement" for purposes of classifying a location as a non-campus building, or property location for purposes of COD Clery Act Geography.
- **Public Property:** All public property, including thoroughfares, streets, sidewalks, and parking facilities, that is within the campus, or immediately adjacent to and accessible from the campus.

Crime Categories

- **Murder/Non-negligent manslaughter:** The willful killing of one human being by another.
- **Negligent Manslaughter:** The killing of another person through gross negligence.
- **Sex Offenses:** Any sexual act directed against another person, forcibly or against that person's will. Includes forcible rape (totaled separately), forcible sodomy, sexual assault with an object and forcible fondling. Also including instances where the victim is incapable of giving consent. This definition includes male and female victims.
 - **Rape:** Penetration, no matter how slight of the vagina or anus with any body part or object. Or oral penetration by a sex organ of another person, without the consent of the victim, including when the victim is incapable of giving consent because of temporary or permanent mental/physical incapacity. This definition includes any gender of victim or perpetrator. This definition of rape now includes "sodomy" and "sexual assault with an object" crime definitions.
 - **Fondling:** The touching of the private body parts of another person for the purpose of sexual gratification without consent of the victim including instances where the victim is incapable of giving consent because of their age or temporary or permanent mental or physical incapacity.
 - **Incest:** Non-forcible sexual intercourse between persons who are related to each other within degrees wherein marriage is prohibited by law.
 - **Statutory Rape:** Non-forcible sexual intercourse with a person who is under the statutory age of consent.
- **Robbery:** The taking or attempting to take anything of value from the care, custody, or control of a person or persons by force or threat of force or violence and/or by putting the victim in fear.
- **Aggravated Assault:** An unlawful attack any one person upon another for the purpose of inflicting severe or aggravated bodily injury. This type of assault usually is accompanied by the use of a weapon or by means likely to produce death or great bodily harm. (It is not necessary that injury result from an aggravated assault when a gun, knife, or other weapon is used which could and probably would result in serious personal injury if the crime were successfully completed).
- **Burglary:** The unlawful entry of a structure to commit a felony or a theft (excludes burglary from vehicles). An incident must meet three conditions to be classified as a burglary: (1) there must be evidence of unlawful entry – no force is counted; (2) the unlawful entry must occur within a structure (four walls, a roof and a door); and (3) the unlawful entry into a structure must show evident that

the entry was made in order to commit a felony or theft. If the intent was not to commit a felony or theft or if the intent cannot be determined the proper classification is "Larceny" (which is not a CLERY reportable crime).

- **Motor Vehicle Theft:** The theft or attempted theft of a motor vehicle. This applies to automobiles, trucks/buses, motorcycles, motorized carts and other vehicles (includes all joy-riding incidents and attempts).
- **Arson:** Any willful or malicious burning or attempt to burn, with or without intent to defraud, a dwelling, house, public building, motor vehicle or aircraft or personal property of another.
- **Domestic Violence:** The term "domestic violence" includes felony or misdemeanor crimes of violence committed by (1) a current or former spouse or intimate partner of the victim (2) by a person with whom the victim shares a child in common, (3) by a person who is cohabitating with or has cohabitated with the victim as a spouse or intimate partner, (4) by a person similarly situated to a spouse of the victim under the domestic or family violence laws of the jurisdiction in which the crime of violence occurred (5) or by any other person against an adult or youth victim who is protected from that person's acts under the domestic or family violence laws of the jurisdiction in which the crime of violence occurred.
- **Dating Violence:** The term "dating violence" means violence committed by a person (acts that are considered "Domestic Violence" are excluded under this definition): A. who is or has been in a social relationship of a romantic or intimate nature with the victim; and B. where the existence of such a relationship shall be determined based on a consideration of the following factors and on the reporting party's statement:
 - The length of the relationship
 - The type of relationship
 - The frequency of the interaction between the persons involved in the relationship
- **Stalking:** The term "stalking" means engaging in a course of conduct (two or more acts) directed at a specific person that would cause a reasonable person to: (1) fear for the person's safety or the safety of others; or (2) suffer substantial emotional distress.
 - Course of conduct means two or more acts, including, but not limited to, acts in which the stalker directly, indirectly or through third parties, by any action, method, device or means, follows, monitors, observes, surveils, threatens or communicates to or about a person or interferes with a person's property.
 - Reasonable person means a reasonable person under similar circumstances and with similar identities to the victim. *Substantial emotional distress means significant mental suffering or anguish that may, but does not necessarily, require medical or other professional treatment or counseling.

- **Hate Crimes:** Any of the previously listed crimes and any other crime involving bodily injury, theft, intimidation, assault or destruction/damage/vandalism reported to the police or to a campus security authority in which the victim is intentionally selected because of the actual or perceived race, gender, religion, sexual orientation, ethnicity or disability of the victim.
- **Drug/Narcotic Law Violations:** The unlawful possession, sale, use, transportation, growing, cultivation, manufacturing, making, distribution, purchase, importation of any controlled drug or narcotic substance. Also, violations of laws prohibiting the use of the equipment or devices utilized in their preparation and/or use. The relevant substances include: opium or cocaine and their derivatives (Morphine, Heroin, Codeine); marijuana; synthetic narcotics (Demerol, Methadone); and dangerous non-narcotic drugs (barbiturates, Benzedrine).
- **Alcohol Law Violations:** The unlawful possession, sale, transportation, manufacturing, purchase, use of alcoholic beverages as well as furnishing alcohol to a minor (under 21 years), maintaining unlawful drinking places, bootlegging and operating a still, using a vehicle for illegal transportation of liquor, and attempts to commit any of the above. Driving under the influence and drunkenness violations are excluded.
- **Weapon Law Violations:** The unlawful possession or control of any firearm, deadly weapon (including nunchakus or billy club), illegal knife or explosive device while on District property except as required in the lawful course of business or as authorized by the Director of Public Safety and Emergency Preparedness. Additionally, the unlawful manufacture, sale, purchase, transportation, possession, concealment or use of firearms, cutting instruments, explosives, incendiary devices or other deadly weapons.

College of the Desert CLERY Act Crime Statistics

As mandated under the CLERY ACT, the following three calendar years of crime statistics (2016-2018) have been compiled by the College of the Desert Public Safety Department, Desert Community College District (DCCD), in conjunction with local law enforcement agencies surrounding the campus. Campus crime, arrest and referral statistics include those reported to the College of the Desert Public Safety Department, campus security authorities, and local law enforcement agencies.

Murder, Non-Negligent Manslaughter

Campus/Location	On-Campus			Non-Campus			Public Property			Unfounded		
Year	20	21	22	20	21	22	20	21	22	20	21	22
Palm Desert	0	0	0	0	0	0	0	0	0	0	0	0
East Valley Indio	0	0	0	0	0	0	0	0	0	0	0	0
West Valley Palm Springs	0	0	0	0	0	0	0	0	0	0	0	0
Mecca Thermal	0	0	0	0	0	0	0	0	0	0	0	0
DHS/Wenzlaff	0	0	0	0	0	0	0	0	0	0	0	0
PaCE Westfield Mall	0	0	0	0	0	0	0	0	0	0	0	0
KCOD	0	0	0	0	0	0	0	0	0	0	0	0

Negligent Manslaughter

Campus/Location	On-Campus			Non-Campus			Public Property			Unfounded		
Year	20	21	22	20	21	22	20	21	22	20	21	22
Palm Desert	0	0	0	0	0	0	0	0	0	0	0	0
East Valley Indio	0	0	0	0	0	0	0	0	0	0	0	0
West Valley Palm Springs	0	0	0	0	0	0	0	0	0	0	0	0
Mecca Thermal	0	0	0	0	0	0	0	0	0	0	0	0
DHS/Wenzlaff	0	0	0	0	0	0	0	0	0	0	0	0
PaCE Westfield Mall	0	0	0	0	0	0	0	0	0	0	0	0
KCOD	0	0	0	0	0	0	0	0	0	0	0	0

Sex Offenses, Rape

Campus/Location	On-Campus			Non-Campus			Public Property			Unfounded		
Year	20	21	22	20	21	22	20	21	22	20	21	22
Palm Desert	0	0	0	0	0	0	0	0	0	0	0	0
East Valley Indio	0	0	0	0	0	0	0	0	0	0	0	0
West Valley Palm Springs	0	0	0	0	0	0	0	0	0	0	0	0
Mecca Thermal	0	0	0	0	0	0	0	0	0	0	0	0
DHS/Wenzlaff	0	0	0	0	0	0	0	0	0	0	0	0
PaCE Westfield Mall	0	0	0	0	0	0	0	0	0	0	0	0
KCOD	0	0	0	0	0	0	0	0	0	0	0	0

Sex Offenses, Fondling

Campus/Location	On-Campus			Non-Campus			Public Property			Unfounded		
Year	20	21	22	20	21	22	20	21	22	20	21	22
Palm Desert	0	1	0	0	0	0	0	0	0	0	1	1
East Valley Indio	0	0	0	0	0	0	0	0	0	0	0	0
West Valley Palm Springs	0	0	0	0	0	0	0	0	0	0	0	0
Mecca Thermal	0	0	0	0	0	0	0	0	0	0	0	0
DHS/Wenzlaff	0	0	0	0	0	0	0	0	0	0	0	0
PaCE Westfield Mall	0	0	0	0	0	0	0	0	0	0	0	0
KCOD	0	0	0	0	0	0	0	0	0	0	0	0

Sex Offenses, Incest

Campus/Location	On-Campus			Non-Campus			Public Property			Unfounded		
Year	20	21	22	20	21	22	20	21	22	20	21	22
Palm Desert	0	0	0	0	0	0	0	0	0	0	0	0
East Valley Indio	0	0	0	0	0	0	0	0	0	0	0	0
West Valley Palm Springs	0	0	0	0	0	0	0	0	0	0	0	0
Mecca Thermal	0	0	0	0	0	0	0	0	0	0	0	0
DHS/Wenzlaff	0	0	0	0	0	0	0	0	0	0	0	0
PaCE Westfield Mall	0	0	0	0	0	0	0	0	0	0	0	0
KCOD	0	0	0	0	0	0	0	0	0	0	0	0

Sex Offenses, Statutory Rape

Campus/Location	On-Campus			Non-Campus			Public Property			Unfounded		
Year	20	21	22	20	21	22	20	21	22	20	21	22
Palm Desert	0	0	0	0	0	0	0	0	0	0	0	0
East Valley Indio	0	0	0	0	0	0	0	0	0	0	0	0
West Valley Palm Springs	0	0	0	0	0	0	0	0	0	0	0	0
Mecca Thermal	0	0	0	0	0	0	0	0	0	0	0	0
DHS/Wenzlaff	0	0	0	0	0	0	0	0	0	0	0	0
PaCE Westfield Mall	0	0	0	0	0	0	0	0	0	0	0	0
KCOD	0	0	0	0	0	0	0	0	0	0	0	0

Robbery

Campus/Location	On-Campus			Non-Campus			Public Property			Unfounded		
Year	20	21	22	20	21	22	20	21	22	20	21	22
Palm Desert	0	0	0	0	0	0	0	0	0	0	0	0
East Valley Indio	0	0	0	0	0	0	0	1	0	0	0	0
West Valley Palm Springs	0	0	0	0	0	0	0	0	0	0	0	0
Mecca Thermal	0	0	0	0	0	0	0	0	0	0	0	0
DHS/Wenzlaff	0	0	0	0	0	0	0	0	0	0	0	0
PaCE Westfield Mall	0	0	0	0	0	0	0	0	0	0	0	0
KCOD	0	0	0	0	0	0	0	0	0	0	0	0

Aggravated Assault

Campus/Location	On-Campus			Non-Campus			Public Property			Unfounded		
Year	20	21	22	20	21	22	20	21	22	20	21	22
Palm Desert	0	0	0	0	0	0	0	0	0	0	0	0
East Valley Indio	0	0	0	0	1	0	0	0	0	0	0	0
West Valley Palm Springs	0	0	0	0	0	0	0	0	0	0	0	0
Mecca Thermal	0	0	0	0	0	0	0	0	0	0	0	0
DHS/Wenzlaff	0	0	0	2	0	0	0	0	0	0	0	0
PaCE Westfield Mall	0	0	0	0	0	0	0	0	0	0	0	0
KCOD	0	0	0	0	0	0	0	0	0	0	0	0

Motor Vehicle Theft

Campus/Location	On-Campus			Non-Campus			Public Property			Unfounded		
Year	20	21	22	20	21	22	20	21	22	20	21	22
Palm Desert	1	0	2	0	0	0	0	0	0	1	0	0
East Valley Indio	0	0	0	0	3	0	0	0	0	0	0	0
West Valley Palm Springs	0	0	0	0	0	0	0	0	0	0	0	0
Mecca Thermal	0	0	0	0	0	0	0	0	0	0	0	0
DHS/Wenzlaff	0	0	0	0	0	0	0	0	0	0	0	0
PaCE Westfield Mall	0	0	0	0	0	0	0	0	0	0	0	0
KCOD	0	0	0	0	0	0	0	0	0	0	0	0

Arson

Campus/Location	On-Campus			Non-Campus			Public Property			Unfounded		
Year	20	21	22	20	21	22	20	21	22	20	21	22
Palm Desert	0	0	0	0	0	0	0	0	0	0	0	0
East Valley Indio	0	0	0	0	0	0	0	0	0	0	0	0
West Valley Palm Springs	0	0	0	0	0	0	0	0	0	0	0	0
Mecca Thermal	0	0	0	0	0	0	0	0	0	0	0	0
DHS/Wenzlaff	0	0	0	0	0	0	0	0	0	0	0	0
PaCE Westfield Mall	0	0	0	0	0	0	0	0	0	0	0	0
KCOD	0	0	0	0	0	0	0	0	0	0	0	0

Burglary

Campus/Location	On-Campus			Non-Campus			Public Property			Unfounded		
Year	20	21	22	20	21	22	20	21	22	20	21	22
Palm Desert	0	0	3	0	0	0	0	2	0	0	0	0
East Valley Indio	0	0	0	0	4	0	0	0	0	0	0	0
West Valley Palm Springs	1	0	0	0	0	0	0	0	0	0	0	0
Mecca Thermal	1	1	0	0	0	0	0	0	0	0	0	0
DHS/Wenzlaff	0	0	0	0	0	0	0	0	0	0	0	0
PaCE Westfield Mall	0	0	0	0	0	0	0	0	0	0	0	0
KCOD	0	0	0	0	0	0	0	0	0	0	0	0

VAWA – Domestic Violence

Campus/Location	On-Campus			Non-Campus			Public Property			Unfounded		
Year	20	21	22	20	21	22	20	21	22	20	21	22
Palm Desert	0	0	0	0	0	0	0	0	0	0	0	0
East Valley Indio	0	0	0	0	0	0	0	0	0	0	0	0
West Valley Palm Springs	0	0	0	0	0	0	0	0	0	0	0	0
Mecca Thermal	0	0	0	0	0	0	0	0	0	0	0	0
DHS/Wenzlaff	0	0	0	0	0	0	0	0	0	0	0	0
PaCE Westfield Mall	0	0	0	0	0	0	0	0	0	0	0	0
KCOD	0	0	0	0	0	0	0	0	0	0	0	0

VAWA – Dating Violence

Campus/Location	On-Campus			Non-Campus			Public Property			Unfounded		
Year	20	21	22	20	21	22	20	21	22	20	21	22
Palm Desert	0	0	0	0	0	0	0	0	0	0	0	0
East Valley Indio	0	0	0	0	0	0	0	0	0	0	0	0
West Valley Palm Springs	0	0	0	0	0	0	0	0	0	0	0	0
Mecca Thermal	0	0	0	0	0	0	0	0	0	0	0	0
DHS/Wenzlaff	0	0	0	0	0	0	0	0	0	0	0	0
PaCE Westfield Mall	0	0	0	0	0	0	0	0	0	0	0	0
KCOD	0	0	0	0	0	0	0	0	0	0	0	0

VAWA – Stalking

Campus/Location	On-Campus			Non-Campus			Public Property			Unfounded		
Year	20	21	22	20	21	22	20	21	22	20	21	22
Palm Desert	0	0	0	0	0	0	0	0	0	1	1	1
East Valley Indio	0	0	0	0	0	0	0	0	0	0	0	0
West Valley Palm Springs	0	0	0	0	0	0	0	0	0	0	0	0
Mecca Thermal	0	0	0	0	0	0	0	0	0	0	0	0
DHS/Wenzlaff	0	0	0	0	0	0	0	0	0	0	0	0
PaCE Westfield Mall	0	0	0	0	0	0	0	0	0	0	0	0
KCOD	0	0	0	0	0	0	0	0	0	0	0	0

Liquor Law Violations

Campus/Location	On-Campus			Non-Campus			Public Property			Unfounded		
Year	20	21	22	20	21	22	20	21	22	20	21	22
Palm Desert	1	0	1	0	0	0	0	0	0	0	0	0
East Valley Indio	0	0	2	0	0	0	0	0	0	0	0	0
West Valley Palm Springs	0	0	0	0	0	0	0	0	0	0	0	0
Mecca Thermal	0	0	0	0	0	0	0	0	0	0	0	0
DHS/Wenzlaff	0	0	0	0	0	0	0	0	0	0	0	0
PaCE Westfield Mall	0	0	0	0	0	0	0	0	0	0	0	0
KCOD	0	0	0	0	0	0	0	0	0	0	0	0

Liquor Law Arrests

Campus/Location	On-Campus			Non-Campus			Public Property			Unfounded		
Year	20	21	22	20	21	22	20	21	22	20	21	22
Palm Desert	0	0	0	0	0	0	0	0	0	0	0	0
East Valley Indio	0	0	0	0	0	0	0	0	0	0	0	0
West Valley Palm Springs	0	0	0	0	0	0	0	0	0	0	0	0
Mecca Thermal	0	0	0	0	0	0	0	0	0	0	0	0
DHS/Wenzlaff	0	0	0	0	0	0	0	0	0	0	0	0
PaCE Westfield Mall	0	0	0	0	0	0	0	0	0	0	0	0
KCOD	0	0	0	0	0	0	0	0	0	0	0	0

Drug Law Violations

Campus/Location	On-Campus			Non-Campus			Public Property			Unfounded		
Year	20	21	22	20	21	22	20	21	22	20	21	22
Palm Desert	0	0	0	0	0	0	0	0	0	0	0	0
East Valley Indio	0	0	0	0	0	0	0	0	0	0	0	0
West Valley Palm Springs	0	0	0	0	0	0	0	0	0	0	0	0
Mecca Thermal	0	0	0	0	0	0	0	0	0	0	0	0
DHS/Wenzlaff	0	0	0	0	0	0	0	0	0	0	0	0
PaCE Westfield Mall	0	0	0	0	0	0	0	0	0	0	0	0
KCOD	0	0	0	0	0	0	0	0	0	0	0	0

Drug Law Arrests

Campus/Location	On-Campus			Non-Campus			Public Property			Unfounded		
Year	20	21	22	20	21	22	20	21	22	20	21	22
Palm Desert	0	0	0	0	0	0	0	0	0	0	0	0
East Valley Indio	0	0	0	0	0	0	0	0	0	0	0	0
West Valley Palm Springs	0	0	0	0	0	0	0	0	0	0	0	0
Mecca Thermal	0	0	0	0	0	0	0	0	0	0	0	0
DHS/Wenzlaff	0	0	0	0	0	0	0	0	0	0	0	0
PaCE Westfield Mall	0	0	0	3	0	0	0	0	0	0	0	0
KCOD	0	0	0	0	0	0	0	0	0	0	0	0

Weapons Law Violations

Campus/Location	On-Campus			Non-Campus			Public Property			Unfounded		
Year	20	21	22	20	21	22	20	21	22	20	21	22
Palm Desert	0	0	0	0	0	0	0	0	0	1	0	0
East Valley Indio	0	0	0	0	0	0	0	0	0	0	0	0
West Valley Palm Springs	0	0	0	0	0	0	0	0	0	0	0	0
Mecca Thermal	0	0	0	0	0	0	0	0	0	0	0	0
DHS/Wenzlaff	0	0	0	0	0	0	0	0	0	0	0	0
PaCE Westfield Mall	0	0	0	0	0	0	0	0	0	0	0	0
KCOD	0	0	0	0	0	0	0	0	0	0	0	0

Weapons Law Arrests

Campus/Location	On-Campus			Non-Campus			Public Property			Unfounded		
Year	20	21	22	20	21	22	20	21	22	20	21	22
Palm Desert	0	0	0	0	0	0	0	0	0	0	0	0
East Valley Indio	0	0	0	0	0	0	0	0	0	0	0	0
West Valley Palm Springs	0	0	0	0	0	0	0	0	0	0	0	0
Mecca Thermal	0	0	0	0	0	0	0	0	0	0	0	0
DHS/Wenzlaff	0	0	0	0	0	0	0	0	0	0	0	0
PaCE Westfield Mall	0	0	0	0	0	0	0	0	0	0	0	0
KCOD	0	0	0	0	0	0	0	0	0	0	0	0

Hate Crimes for All Campuses

2022: No hate crimes were reported.

2021: No hate crimes were reported.

2020: No hate crimes were reported.

Additional Statistics Required by Education Code 67380

Violent Crimes

Campus/Location	On-Campus			Non-Campus			Public Property			Unfounded		
Year	20	21	22	20	21	22	20	21	22	20	21	22
Palm Desert	0	0	0	0	0	0	0	0	0	0	0	0
East Valley Indio	0	0	0	0	0	0	0	0	0	0	0	0
West Valley Palm Springs	0	0	0	0	0	0	0	0	0	0	0	0
Mecca Thermal	0	0	0	0	0	0	0	0	0	0	0	0
DHS/Wenzlaff	0	0	0	0	0	0	0	0	0	0	0	0
PaCE Westfield Mall	0	0	0	0	0	0	0	0	0	0	0	0
KCOD	0	0	0	0	0	0	0	0	0	0	0	0

Theft of Property

Campus/Location	On-Campus			Non-Campus			Public Property			Unfounded		
Year	20	21	22	20	21	22	20	21	22	20	21	22
Palm Desert	0	0	1	0	0	0	0	0	0	1	1	0
East Valley Indio	0	0	0	0	5	0	0	0	0	0	0	0
West Valley Palm Springs	0	3	0	0	0	0	0	0	0	0	0	0
Mecca Thermal	1	0	0	0	0	0	0	0	0	0	0	0
DHS/Wenzlaff	0	0	0	0	0	0	0	0	0	0	0	0
PaCE Westfield Mall	0	0	0	0	0	0	0	0	0	0	0	0
KCOD	0	0	0	0	0	0	0	0	0	0	0	0

Destruction of Property

Campus/Location	On-Campus			Non-Campus			Public Property			Unfounded		
Year	20	21	22	20	21	22	20	21	22	20	21	22
Palm Desert	14	6	4	0	0	0	0	0	0	0	0	0
East Valley Indio	7	0	0	0	0	0	0	0	0	0	0	0
West Valley Palm Springs	1	2	3	0	0	0	0	0	0	0	0	0
Mecca Thermal	1	0	0	0	0	0	0	0	0	0	0	0
DHS/Wenzlaff	0	0	0	0	0	0	0	0	0	0	0	0
PaCE Westfield Mall	0	0	0	0	0	0	0	0	0	0	0	0
KCOD	0	0	0	0	0	0	0	0	0	0	0	0