

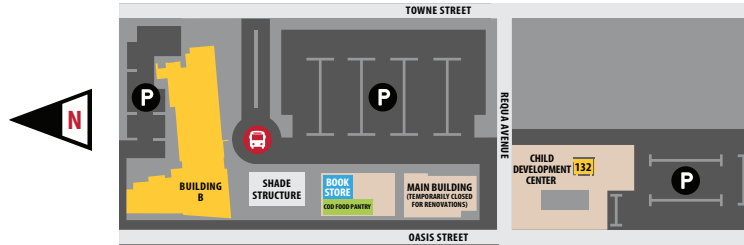

## INDIO CAMPUS EXPANSION

45524 OASIS STREET, INDIO, CA 92201  
LAST UPDATED: 11/03/2024



### DRIVING DIRECTIONS FROM INTERSTATE 10:

TAKE I-10 EAST  
EXIT JACKSON STREET (EXIT 143)  
TURN RIGHT ONTO REQUA AVENUE  
TURN RIGHT ONTO OASIS STREET  
INDIO CAMPUS IS ON THE RIGHT

- COD CLASSROOMS
- COMMON AREAS
- NOT ACCESSIBLE TO PUBLIC
- ACCESSIBLE TO PUBLIC
- P PARKING
- EXIT EMERGENCY EXIT
- ♂ ♀ RESTROOMS
- ♂ ♀ GENDER NEUTRAL RESTROOM
- BUS BUS STOP
- ELEVATOR ELEVATORS
- WATER WATER BOTTLE FILLING STATION
- LACTATION LACTATION ROOM
- AED AED
- CHAIR EMERGENCY EVACUATION CHAIR
- SAFETY PUBLIC SAFETY 442-666-9439

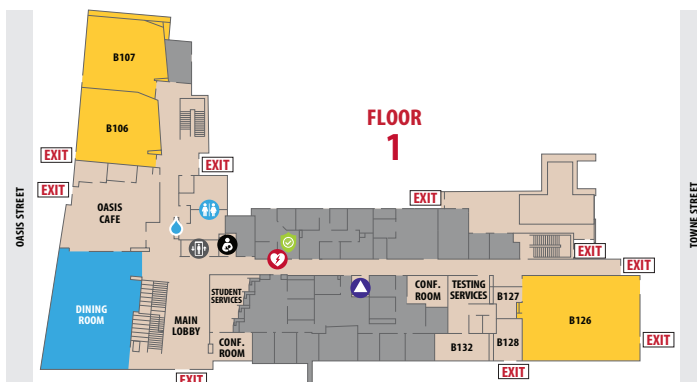
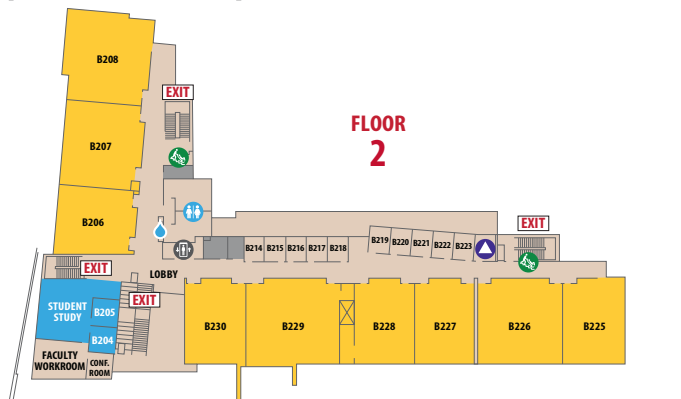

## College of the Desert - Indio

### Biology

**BI 013** is the first of a two course sequence that offers an in depth study of the human body. This course covers anatomical terminology, cells and tissues, the integumentary system, the skeletal system, articulations, the muscular system, the nervous system and special senses.

Prerequisite: MATH 054 Advisory: ENG 061 IGETC: 5B, 5C

0632	BI 013	ANAT & PHYS I	4.0	09:00a-10:30a	MTWR	NDIOB303	Tesch,A
------	--------	---------------	-----	---------------	------	----------	---------

**Note: 8 week class: 06/09 - 07/31** 10:45a-12:15p MTWR NDIOB229

Note: This OFF-CAMPUS CLASS meets at the Indio Campus, 45524 Oasis Street, Indio. Students at off-campus sites should allow sufficient travel time to arrive on time and remain for the duration of the class. Non-Participation and excessive absences may be grounds for being dropped from a course.

Note: No class meetings June 19 and July 3

0672	BI 013	ANAT & PHYS I	4.0	02:00p-03:30p	MTWR	NDIOB303	Tesch,A
------	--------	---------------	-----	---------------	------	----------	---------

**Note: 8 week class: 06/09 - 07/31** 03:45p-05:15p MTWR NDIOB229

Note: This OFF-CAMPUS CLASS meets at the Indio Campus, 45524 Oasis Street, Indio. Students at off-campus sites should allow sufficient travel time to arrive on time and remain for the duration of the class. Non-Participation and excessive absences may be grounds for being dropped from a course.

Note: No class meetings June 19 and July 3

### Counseling

**COUN 300** provides an introduction to College of the Desert for all incoming college students. Through this course, students will gain an understanding of our college structure, academic programs offered, student planning, financial aid, college expectations and support services. Students receive a Pass/No Pass grade mark.

9322	COUN 300	STUD DEV EDGE	0.0	09:00a-10:50a	MW	NDIOB328	STAFF
------	----------	---------------	-----	---------------	----	----------	-------

**Note: 3 week class: 06/09 - 06/25**

9326	COUN 300	STUD DEV EDGE	0.0	12:00p-01:50p	MW	NDIOB302	STAFF
------	----------	---------------	-----	---------------	----	----------	-------

**Note: 3 week class: 06/09 - 06/25**

9324	COUN 300	STUD DEV EDGE	0.0	10:00a-12:10p	TR	NDIOB302	STAFF
------	----------	---------------	-----	---------------	----	----------	-------

**Note: 3 week class: 06/10 - 06/26**

Note: No class meeting June 19th

9330	COUN 300	STUD DEV EDGE	0.0	05:00p-06:50p	MW	NDIOB302	STAFF
------	----------	---------------	-----	---------------	----	----------	-------

**Note: 3 week class: 06/09 - 06/25**

9364	COUN 300	STUD DEV EDGE	0.0	09:00a-10:50a	MW	NDIOB328	STAFF
------	----------	---------------	-----	---------------	----	----------	-------

**Note: 3 week class: 06/30 - 07/16**

### Child Development & Education

**CDE 204** explores the application of child development theory to facilitate learning among young children, including: promoting self esteem, creativity, self discipline, development of physical and cognitive skills and literacy, and planning appropriate curriculum along with professional development of the teacher. Prerequisite: CDE 101 & CDE 102 & CDE 103 & CDE 104 & CDE 203 (formerly ECE 001, ECE 010, ECE 012, ECE 040 & ECE 046B)

0771	CDE 204	PRACTICUM	4.0	144 TOTAL HRS	TBA	HYFLEX	Avalos,M
------	---------	-----------	-----	---------------	-----	--------	----------

**Note: 8 week class: 06/09 - 07/31**

Note: Choose how you attend class: (1) in-class physically Monday at 5:00pm-8:45pm at the Child Development Center, 45742 Oasis Street, room NDIO 132, Indio, (2) live streaming class at the same days and times via Zoom, or (3) watching Zoom recordings on your own. You have the flexibility to attend any way your schedule permits. Additional work is completed and submitted online via Canvas. HyFlex courses help you complete your education while allowing you to adapt it to your life. Students must access Canvas at [www.collegeofthedesert.edu/on](http://www.collegeofthedesert.edu/on) or before June 9th, to begin the course.

Note: Students will complete student teaching practicum hours (108 hours) with a Mentor Teacher at sites in the Coachella Valley or with a Child Development Specialist at the COD McCarthy Family Child Development and Training Center.

Note: Students are required to have a valid TB skin test prior to working with children and can obtain it through the college by emailing the professor, [maavalos@collegeofthedesert.edu](mailto:maavalos@collegeofthedesert.edu). Additional immunizations/vaccinations MMR, Tdap, COVID) will be required before starting lab hours.

**DIRECTIONS** see map on page 42 of this class schedule for directions to the Indio Campus.

All classes with "**NDIO**" rooms meet at the Indio Campus, 45524 Oasis Street, Indio.

There are additional off site locations on page 45. See section note for exact location.

For more information about our Indio location, registration and classes, call (760) 776-7200

**Tutoring & Academic Skills Center (TASC)**  
June 9 - July 31  
 (760) 773-2557

Monday - Thursday  
 8:00 a.m. - 6:00 p.m.  
 subject to change without notice.

Students at off campus sites should allow sufficient travel time to arrive on time and remain for the duration of the class. Non-participation and excessive absences may be grounds for being dropped from a course.

### Department of Public Safety

Indio Campus  
 (442) 400-5311  
 or  
 EXT 5311  
 or  
 (442) 666-9439 (cell)  
 (442) 666-9438 (cell)

**Evening Classes**  
**appear in BOLD print**  
**throughout this**  
**schedule.**

**COD - East Valley**

To learn more about the East Valley Education Centers, call 760-776-7200, visit us online at [www.college-ofthedesert.edu/indio](http://www.college-ofthedesert.edu/indio), or email [offcampussites@collegeofthedesert.edu](mailto:offcampussites@collegeofthedesert.edu).

**Self Service**

College of the Desert has transitioned to a new way of registering and making changes to your class schedule.

Self Service is available for Summer and Fall registration.

Check out the information on page 7 of this class schedule. Watch the COD website for more details.

## Adult Basic Education (ABE) and English As A Second Language (ESLN) Registration

Registration for new/continuing ABE students will begin on 4/15/2025.

English As A Second Language (ESLN) Registration:

Registration for new and continuing students will begin on 04/15/2025.

Please visit the College of the Desert Admissions webpage and click on the Adult Basic Education Registration link or the English As A Second Language link for details.

SECT	COURSE	TITLE	U	TIME	DAYS	BLDG/RM	INSTRUCTOR
------	--------	-------	---	------	------	---------	------------

## Disabled Students Programs & Services

**DSPS 315** is designed to support new college students with disabilities master the skills required to be a successful college student. Some of the topics include basic college technology skills, navigating the college systems, self-advocacy, and resources for success.

Students receive a Pass/No Pass grade mark.

8834	DSPS 315	DSPS TRANSITION	0.0	09:00a-10:15a	MW	NDIOB302	Cambron,P
	<b>Note: 8 week class: 06/09 - 07/30</b>			18 TOTAL HRS	TBA	HYBRID	
Note: This is a hybrid online class that meets in person on Mondays and Wednesdays OFF-CAMPUS at the Indio Campus, 45524 Oasis Street. All remaining required hours will be asynchronous online in addition to homework assignments.							

## English

**ENG 300** prepares incoming college students for the rigors of college-level reading and writing, and college-level English courses specifically. Students will learn and/or review the academic norms that lead to academic success and some foundational essay-writing concepts. Students receive a Pass/No Pass grade mark.

9321	ENG 300	ENGLISH EDGE	0.0	09:00a-10:50a	TR	NDIOB226	Spence,C
	<b>Note: 3 week class: 06/09 - 06/26</b>			12 TOTAL HRS	TBA	HYBRID	
Note: This is a hybrid class with in person meetings on Tuesdays and Thursdays. All required remaining hours will be online in addition to homework assignments.							
Note: No class meeting June 19							
9329	ENG 300	ENGLISH EDGE	0.0	05:00p-06:50p	TR	NDIOB226	Hernandez,M
	<b>Note: 3 week class: 06/09 - 06/26</b>			12 TOTAL HRS	TBA	HYBRID	
Note: This is a hybrid class with in person meetings on Tuesdays and Thursdays. All required remaining hours will be online in addition to homework assignments.							
Note: No class meeting June 19							
9345	ENG 300	ENGLISH EDGE	0.0	09:00a-10:50a	MW	NDIOB226	Rivera,J
	<b>Note: 3 week class: 06/30 - 07/17</b>			12 TOTAL HRS	TBA	HYBRID	
Note: This is a hybrid class with in person meetings on Mondays and Wednesdays. All required remaining hours will be online in addition to homework assignments.							
9561	ENG 300	ENGLISH EDGE	0.0	09:00a-10:50a	MW	NDIOB226	Rivera,J
	<b>Note: 3 week class: 07/21 - 08/07</b>			12 TOTAL HRS	TBA	HYBRID	
Note: This is a hybrid class with in person meetings on Mondays and Wednesdays. All required remaining hours will be online in addition to homework assignments.							
9563	ENG 300	ENGLISH EDGE	0.0	11:00a-12:50p	MW	NDIOB226	McKowan,C
	<b>Note: 3 week class: 07/21 - 08/07</b>			12 TOTAL HRS	TBA	HYBRID	
Note: This is a hybrid class with in person meetings on Mondays and Wednesdays. All required remaining hours will be online in addition to homework assignments.							

## English As A Second Language - Noncredit

Note: ESLN classes are 8 weeks starting June 9th and ending July 31st. Some classes are taught on TechConnect Zoom with assignments completed on Canvas, other sections meet in person. Students receive a Pass/No Pass grade mark.

**ESLN 387A** is the foundations-level vocabulary and beginning conversation practice using learned vocabulary on everyday life topics.

7948	ESLN 387A	ESL - CONVERSATION BEG	0.0	06:00p-07:50p	MTWR	NDIOB227	Camacho,A
------	-----------	------------------------	-----	---------------	------	----------	-----------

**ESLN 388A** is the low beginning conversation practice using learned vocabulary on everyday life topics.

Prerequisite: ESLN 387A, or appropriate ESLN Placement Test, or Instructor recommendation

7954	ESLN 388A	ESL - CONVERSATION I	0.0	06:00p-07:50p	MTWR	NDIOB225	Church,M
------	-----------	----------------------	-----	---------------	------	----------	----------

**ESLN 388B** is the high beginning conversation practice using learned vocabulary on everyday life topics.

Prerequisite: ESLN 388A, or appropriate ESLN Placement Test score, or Instructor recommendation

7984	ESLN 388B	ESL - CONVERSATION II	0.0	06:00p-07:50p	MTWR	NDIOB230	Holster,M
------	-----------	-----------------------	-----	---------------	------	----------	-----------

**ESLN 388C** is the low intermediate conversation practice using learned vocabulary on everyday life topics.

Prerequisite: ESLN 388B, or appropriate ESLN Placement Test score, or Instructor recommendation

7992	ESLN 388C	ESL - CONVERSATION III	0.0	06:00p-07:50p	MTWR	NDIOB228	Lua,A
------	-----------	------------------------	-----	---------------	------	----------	-------

**ESLN 388D** is the high intermediate conversation practice using learned vocabulary in a variety of situations.

Prerequisite: ESLN 388C, or appropriate ESLN Placement Test score, or Instructor recommendation

7782	ESLN 388D	ESL - CONVERSATION IV	0.0	06:00p-07:50p	MTWR	NDIOB329	Hummer,K
------	-----------	-----------------------	-----	---------------	------	----------	----------

SECT	COURSE	TITLE	U	TIME	DAYS	BLDG/RM	INSTRUCTOR
------	--------	-------	---	------	------	---------	------------

INDIO

45

## Mathematics

**MATH 001B** is the second semester of Calculus. It covers methods and applications of integration and infinite series. Prerequisite: MATH-001A IGETC: 2A

0341 MATH 001B CALCULUS II 4.0 11:00a-02:20p MTWR NDI0B206 Podlesny,B  
**Note: 8 week class: 06/09 - 07/31**  
 Note: No class meetings June 19 and July 3

**MATH 005** is the first of a two semester sequence preparing students for Calculus. In this course, students will study functions with an emphasis on the trigonometric functions along with topics in analytic geometry. Prerequisite: MATH 049 or qualifying placement,

Advisory: ENG 001A and Advisory Corequisite: MATH 355A  
 0349 MATH 005 TRIGONOMETRY 5.0 08:00a-10:50a MTWR NDI0B206 Podlesny,B  
**Note: 8 week class: 06/09 - 07/31**

**MATH 010** is a function oriented course including the concept of a function and function notation.

Prerequisite: MATH 049 or qualifying placement, Advisory Prerequisite: ENG 001A and IGETC: 2A  
 Advisory Corequisite: MATH 351  
 0339 MATH 010 COLLEGE ALGEBRA 4.0 02:00p-05:20p MTWR NDI0B328 Palafox,D  
**Note: 8 week class: 06/09 - 07/31**  
 Note: No class meetings June 19 and July 3

**MATH 012** is the second in a two semester sequence preparing students for Calculus. In this course, students will extend the concept of a function to polynomial, rational, exponential and logarithmic functions as well as studying analytic trigonometry. Prerequisite: MATH 005 or qualifying placement,

Advisory Corequisite: MATH 355B IGETC: 2A\*  
 0315 MATH 012 PRE-CALCULUS 5.0 01:00p-03:50p MTWR NDI0B225 McJilton,M  
**Note: 8 week class: 06/09 - 07/31**  
 Note: No class meetings June 19 and July 3

Note: Section 0315 is a DEMAND CLASS and may open for enrollment when other sections have filled.

0319 MATH 012 PRE-CALCULUS 5.0 05:15p-08:05p MTWR NDI0B206 McJilton,M  
**Note: 8 week class: 06/09 - 07/31**  
 Note: No class meetings June 19 and July 3

**MATH 014** is an introduction to descriptive and inferential statistics using measures of central tendency and dispersion of samples, probability, confidence intervals, and hypothesis testing to draw inferences about one or more populations. Prerequisite: MATH 045 or MATH 049 or qualifying placement,

Advisory: ENG 001A and Advisory Corequisite: MATH 310; IGETC: 2A\*  
 0352 MATH 014 STATISTICAL METHODS 4.0 62 TOTAL HRS TBA HYBRID Palafox,D  
**Note: 8 week class: 06/09 - 07/31 05:50p-08:55p TR NDI0B328**

Note: Students must access the lecture portion of this hybrid class at [www.collegeofthedesert.edu/](http://www.collegeofthedesert.edu/) on or before June 9th, to begin the course. All lecture hours will be asynchronous online in addition to homework assignments. All lab hours will be face to face OFF-CAMPUS at the Indio Campus on Tuesdays and Thursdays.

Note: No class meetings June 19 and July 3

**MATH 300** combines a review of mathematical concepts and skills, an introduction to mathematics course offerings at College of the Desert, and guidance in the transition from high school to college mathematics. Students receive a Pass/No Pass grade mark

9458 MATH 300 MATH EDGE 0.0 12:00p-03:05p MTWR NDI0B226 STAFF  
**Note: 3 week class: 06/09 - 06/26**  
 Note: No class meeting June 19

9472 MATH 300 MATH EDGE 0.0 12:00p-03:05p MTWR NDI0B226 STAFF  
**Note: 3 week class: 06/30 - 07/17**  
 Note: No class meeting July 3

### College of the Desert - Mecca/Thermal

9607 COUN 300 STUD DEV EDGE 0.0 11:00a-12:50p TR MECCB6 STAFF  
**Note: 3 week class: 07/22 - 08/07**

### College of the Desert - Desert Hot Springs

9368 COUN 300 STUD DEV EDGE 0.0 09:00a-11:10a TR CDHS41 STAFF  
**Note: 3 week class: 07/01 - 07/17**

Note: This OFF-CAMPUS CLASS meets at the Wenzlaff Center, 11625 West Drive in Desert Hot Springs.  
 Note: No class meeting July 3.



The pLEDGE program provides 2025 high school graduates (or equivalent) from the Coachella Valley with two full years of tuition and fees at College of the Desert!

Participating students will complete at least one EDGE non-credit course to prepare for college and college-level coursework or a credit summer course to be eligible for pLEDGE.

EDGE non-credit courses: English EDGE (ENG-300), Math/Statistics EDGE (MATH-300 or SOC-300), or Student Development EDGE (COUN-300).

Students must also have a completed Financial Aid file, commit to full time enrollment, maintain good academic standing and participate in career preparation and community service. For more information, please contact the pLEDGE office at (760) 636-7970 or [edge@collegeofthedesert.edu](mailto:edge@collegeofthedesert.edu)